

UNEK44
AUSTRALIA
OFF ROAD ACCESSORIES

SKU: TL-LTB-70-ASM0



Fitting Instructions

Toyota Land Cruiser 70 Series

Gutter Mount LED Light Bar Adjustable

***Australia's Best Off Road Products
Created... Not Cloned***

Contents

WHY UNEEK	3
IMPORTANT INFORMATION	4
COMPONENTS AND PARTS	5
STEP 1	6
STEP 2	6
STEP 3	6
FINISHED PRODUCT	7

Why Uneek

Australian Designed and Built

All our products are designed and manufactured right here in Australia, allowing us to have better lead times and better quality control than companies manufacturing overseas. By supporting us you're supporting to grow the Australian economy and our brand.

Uneek Styling

We do not design our bars to look the same across the vehicle range. We fully develop our own product to individually suit each vehicle. We take time in designing from scratch and then test all our bars to comply with all relevant ADRs and Australian Standards.

Lightweight Through Smart Engineering

Having a steel bar doesn't mean you have to add more weight than is required to the front of your vehicle. Our engineering practises ensure we have the right protection, designed the right way to ensure protection is at its maximum and weights at its minimum.

Proven Off Road

We take our products out and test them right here in the heart of our country in our Australian conditions so we know our products can withstand anything you throw at them.

Increased Approach Angles

Our bars are designed to give you the best advantage while off road, with increased approach angles means you can tackle those tough and steep angles better than you could with the original setup or other alternatives.

Warranty

Uneek 4x4 back itself as Australia's leading steel bull bar manufacturer. This is why we provide you with the best steel bar warranty in Australia - 5 years.

Important Information



PLEASE READ BEFORE INSTALLATION.

- This product must be installed exactly as per these instructions using only hardware supplied.
- Make sure you check local road laws to see if having a light bar on your roof is legal and switching requirements.
- Take a few moments to read instructions thoroughly before beginning work.
- In the event of damage to any component please contact Uneek 4x4 in regards to repair/replacement of components.
- These Brackets are designed to work with most 48-52" end mounted light bars single row, and double row including curved light bars.
- This product and its fixings must not be modified in any way unless stated in these fitting instructions.
- These instructions are correct at time of publication. Uneek 4x4 cannot be held responsible for the impact of any changes subsequently made by the vehicle manufacturer.
- During installation it is the duty of the installer to check correct operation/clearances of all components.
- Installation time: 20 min.
- If you experience excessive whistling from the light bar once mounted you can try and move the light bar back along the gutters to reduce the noise or purchase some ¼" irrigation hose and secure it inside the fins of the light bar to reduce the noise. In most cases this is not necessary.

Components and parts

ITEM NO.	PART NUMBER	DESCRIPTION	QTY.
1	03-0309R	top mount	1
2	03-0309L	top mount	1
3	03-0788	MOUNT 70 Series	2
4	03-0311	CLAMP	2
5	M8 NYLOC	NYLOC SELF LOCKING NUT, ST STL A2 ISO	4
6	M8 WASHER	M8 WASHER	8
7	M8X30 BHCS	M8X30 BUTTON HEAD CAP SCREW Z/P	4
8	PINCH WELD BLACK 70MM	PINCH WELD BLACK 70MM	2
9	M8X16 BHCS	M8X16 BUTTON HEAD CAP SCREW Z/P	4
10	M8 FN	FLANGE NUT M8	4

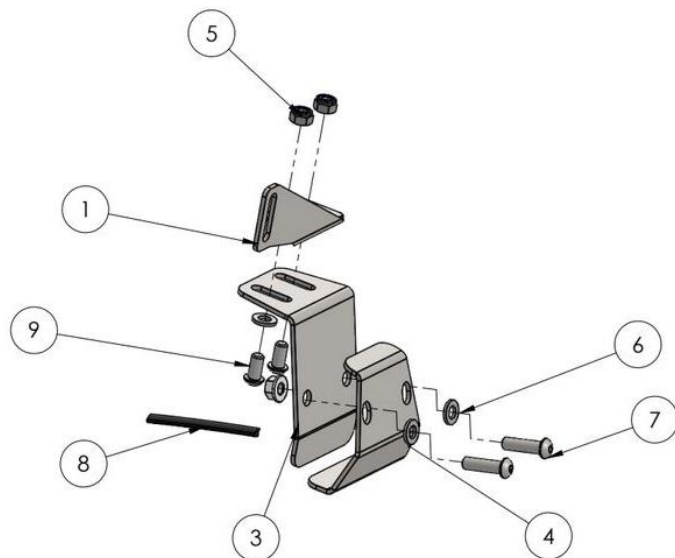
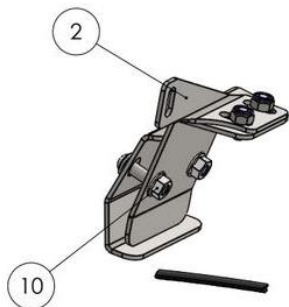

Step 1

- Fit pinch weld on to the bottom of the gutter mount brackets then place top mount on top of gutter bracket using M8x16 BHCS with washer and nyloc nut. The nut must be fitted on the top.
- Leave this bracket loose at this time.
- Repeat for other side.



Step 2

- Fit gutter bracket on to vehicle gutter and feed M8x 30mm bolts through clamp then into gutter bracket and loosely do up the nuts.
- Repeat for other side.



Step 3

- Fit light bar and adjust top mount as required. You may need to swap the top mounts over from left to right to achieve more or less gap between them to suit your light bar.
- Once in position, torque up all bolts.
- Run light bar wires down A pillar and wire up as per wiring loom instructions.



Finished Product



Revised: 25/07/2019

***Australia's Best
Off Road Products
Created... Not Cloned***

49 Pacific Drive, Keysborough, VIC, 3173

1300 806 952

www.uneek4x4.com.au

