

UNEELK4x4
AUSTRALIA
OFF ROAD ACCESSORIES

SKU: AR-B-ASMO



Fitting Instructions
Adventure Rack
Universal Fit

***Australia's Best Off Road Products
Created... Not Cloned***

Contents

WHY BUY UNEEK	3
IMPORTANT INFORMATION	4
COMPONENTS AND PARTS	5
COMPONENTS AND PARTS	6
COMPONENTS AND PARTS	7
COMPONENTS AND PARTS	8
COMPONENTS AND PARTS	9
COMPONENTS AND PARTS	11
STEP 1	12
STEP 2	12
STEP 3	12
STEP 4	12
STEP 5	13
STEP 6	13
STEP 7	13
STEP 8	14
STEP 9	14
STEP 10	14
STEP 11	14
STEP 12	15
STEP 13	15
STEP 14	15
STEP 15	16
FINISHED PRODUCT	17

Why Buy Uneek

Australian Designed and Built

All our products are designed and manufactured right here in Australia, allowing us to have better lead times and better quality control than companies manufacturing overseas. By supporting us you're supporting to grow the Australian economy and our brand.

Uneek Styling

We do not design our bars to look the same across the vehicle range. We fully develop our own product to individually suit each vehicle. We take time in designing from scratch and then test all our bars to comply with all relevant ADRs and Australian Standards.

Lightweight Through Smart Engineering

Having a steel bar doesn't mean you have to add more weight than is required to the front of your vehicle. Our engineering practises ensure we have the right protection, designed the right way to ensure protection is at its maximum and weights at its minimum.

Proven Off Road

We take our products out and test them right here in the heart of our country in our Australian conditions so we know our products can withstand anything you throw at them.

Increased Approach Angles

Our bars are designed to give you the best advantage while off road, with increased approach angles means you can tackle those tough and steep angles better than you could with the original setup or other alternatives.

Warranty

Uneek 4x4 back itself as Australia's leading steel bull bar manufacturer. This is why we provide you with the best steel bar warranty in Australia - 5 years.

Important Information



PLEASE READ BEFORE INSTALLATION.

- This product must be installed exactly as per these instructions using only hardware supplied.
- Take a few moments to read instructions thoroughly before beginning work.
- In the event of damage to any component please contact Uneek 4x4 in regards to repair/replacement of components.
- This product and its fixings must not be modified in any way unless stated in these fitting instructions.
- The installation of this product is recommended for trained personnel or mechanically adept people.
- These instructions are correct at time of publication. Uneek 4x4 cannot be held responsible for the impact of any changes subsequently made by the vehicle manufacturer.
- During installation it is the duty of the installer to check correct operation/clearances of all components.
- Installation time: 2-3 hours.
- This rack is rated to 150kg Dynamic loading (driving) and 300kg static loading (stationary) evenly distributed when installed correctly.
- This rack is adjustable to suit many different tub widths and can accommodate a tub width measured between inside edge of tub 1395mm up to 1580mm.
- This rack is adjustable up and down to suit your needs from 310mm up to 510mm.



EYE & EAR PROTECTION REQUIRED



DRILLING REQUIRED



TWO PERSON LIFT REQUIRED



TORQUE SETTING



CUTTING OR GRINDING REQUIRED

FASTENER TORQUE SETTINGS:

M6 – 9Nm (4lb ft)

M8 – 22Nm (16lb ft)

M10 – 44Nm (32lb ft)

M12 – 77Nm (57lb ft)

TOOLS REQUIRED:

Basic tool kit with spanners, Allen keys and socket set,

Power Drill, with drill bits, centre punch and hammer, G clamp with soft jaws.

Components and parts

Base Rack Standard Length Components: AR-B-ASM0

ITEM NO.	PART NUMBER	DESCRIPTION	QTY.
1	03-0653	AD RACK TUB MOUNT	4
2	03-0655	AD RACK EXTENSION	4
3	03-0657	AD RACK TOP SECTION	2
4	03-0659	AD RACK LONG SPAN RAIL	4
5	03-0661	AD RACK TOP SPAN CONNECTOR	2
6	U4X4-LOGO PLATE- 2	LOGO PLATE SMALL	4
7	03-0517	ad rack combing rail	2
8	04-0463	AD RACK SPACER	4
9	M6 x 16 BHCS	M6 X 16 BHCS	48
10	m6 washer	m6 washer	56
11	M6 NYLOCK NUT	M6 NYLOCK NUT	56
12	M6 x 25 BHCS	M6 X 25 BHCS	8
13	M8 FW X 22	FLAT WASHER 8MM LARGE	72
14	M8X25 BHCS	M8X25 BUTTON HEAD CAP SCREW	29
15	M8 NYLOC	NYLOC SELF LOCKING NUT, ST STL A2 ISO	37
16	M8X45 BHCS	M8X45 BUTTON HEAD CAP SCREW Z/P	8

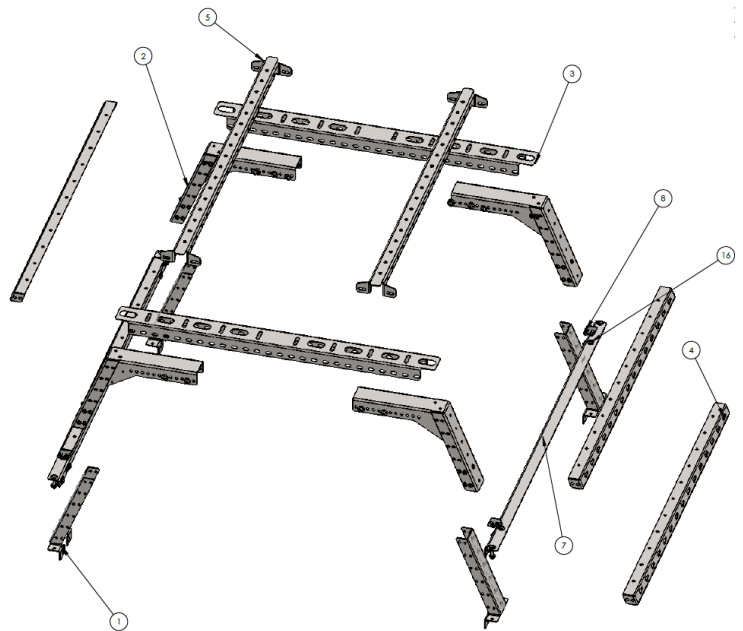

Short Length Base rack (AR-BS-ASM0) is same as above with 03-0685 in lieu of 03-0659, 03-0687 in lieu of 03-0661 and 03-0517 Deleted.

Components and parts

Contents Tyre Carrier Standard Length: AR-ASM4

MAIN KIT

ITEM NO.	PART NUMBER	DESCRIPTION	QTY.
1	AR-TC-ASM1	AD RACK TYRE CARRIER	1
2	04-0445	AD RACK TRE CARRIER MNT PLATE	2
3	03-0090	BRACKET ASSY TYRE MOUNT	1

BOLT KIT

ITEM NO.	PART NUMBER	DESCRIPTION	QTY.
4	M10X70	M10x70 HEX 1.5	4
5	M10FWX25	M10 FLAT WASHER X 25MM WIDE	4
6	M10 FN	M10 Flange nut	4
7	M8 X 30	M8 X 30 HEX BOLT 8.8 Z/P	5
8	M8 FN	FLANGE NUT M8	5
9	M8 WASHER	M8 WASHER	5
10	M12X30	M12 X 30 HEX HT	2
11	M12 SW	M12 SPRING WASHER	2
12	M12 FW	M12 FLAT WASHER	2
13	M12x 1.25 wheel nut	M12 x 1.25 Wheel nut	3

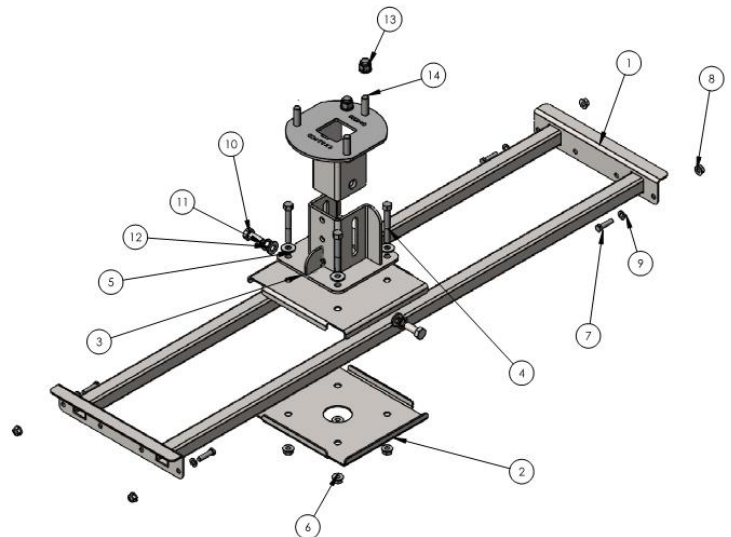

OPTIONS - CHECK ORDER

ITEM NO.	PART NUMBER	DESCRIPTION	QTY.
14	GU-RB-ASM4	TYRE MOUNT	1
15	AR-TC-LR-ASM1	TYRE MOUNT LAND ROVER 5x6.5"	1
16	TL-RB-TM-ASM1	Tyre Mount ASSY Toyota LC 5x150	1

Tyre Carrier SHORT Length, AR-ASM4S, is same as AR-ASM4 with short version Tyre Carrier AR-TC-ASM7 in lieu of AR-TC-ASM1

Components and parts

Mountain Top Roller shutter Brackets:

ASM3 (FLAT Roller Shutter Top) Contents

ITEM NO.	PART NUMBER	DESCRIPTION	QTY.
1	03-0683	AD RACK ROLLER SHUTTER MOUNT	4
2	M6 x 12 BHCS	M6 x 12 BHCS z/p	8
3	04-0696	NUT PLATE M6 - RANGER WILDTRACK	8
4	M6 FW	FLAT WASHER 6MM	8

AR-ASM3 (FLAT)

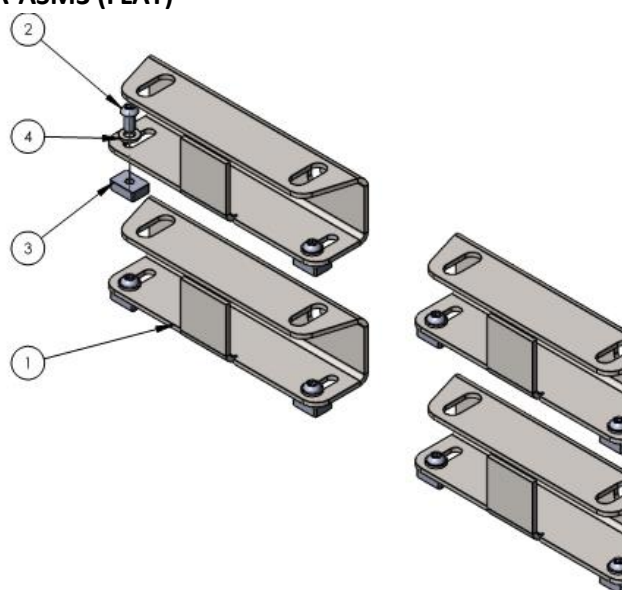

ASM9 (ANGLED Roller Shutter Top) Contents

ITEM NO.	PART NUMBER	DESCRIPTION	QTY.
1	03-0776	AD RACK ROLLER SHUTTER MOUNT ANGLED	4
2	M6 x 12 BHCS	M6 x 12 BHCS z/p	8
3	04-0696	NUT PLATE M6 - RANGER WILDTRACK	8
4	M6 FW	FLAT WASHER 6MM	8

AR-ASM9 (ANGLED)

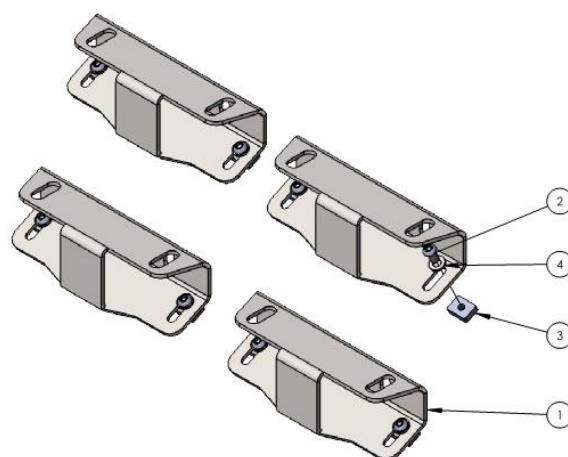

Components and parts

If fitting to a Ranger or BT-50 with out a roller shutter 2
reinforcing brackets are required:
Part number: 04-0465

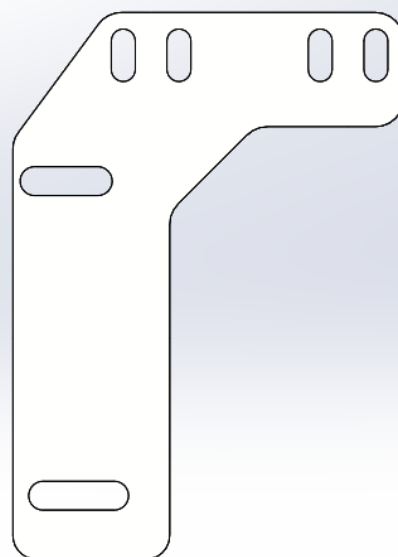

Contents if purchasing a shovel or axe mount,
Depending on where you fit this you may need an
additional long span rail (AR-ASM11 or AR-ASM11S).



Components and parts

Contents if purchasing 60" Hi-Lift Jack Mount.



Contents if purchasing 48” Hi-Lift Jack Mount (AR-ASM8).

ITEM NO.	PART NUMBER	DESCRIPTION	QTY.
1	03-0659	AD RACK LONG SPAN RAIL	1
2	M6 FLANGE NUT	M6 FLANGE NUT	4
3	M6 FLAT WASHER	M6 FLAT WASHER	4
4	M6 x 25 BHCS	M6 X 25 BHCS	4
5	K9A-149	K9 High Lift Jack Mount Kit	1

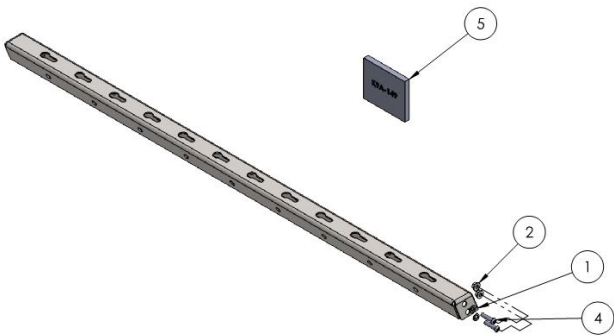

48” Hi Lift Jack mount to suit Short Rack (AR-ASM8S) is same as Above with 03-0685 in lieu of 03-0659.

Contents if purchasing additional long span rail kit (AR-ASM11).

ITEM NO.	PART NUMBER	DESCRIPTION	QTY.
1	03-0659	AD RACK LONG SPAN RAIL	1
2	M6 FLANGE NUT	M6 FLANGE NUT	4
3	M6 FLAT WASHER	M6 FLAT WASHER	4
4	M6 x 25 BHCS	M6 X 25 BHCS	4

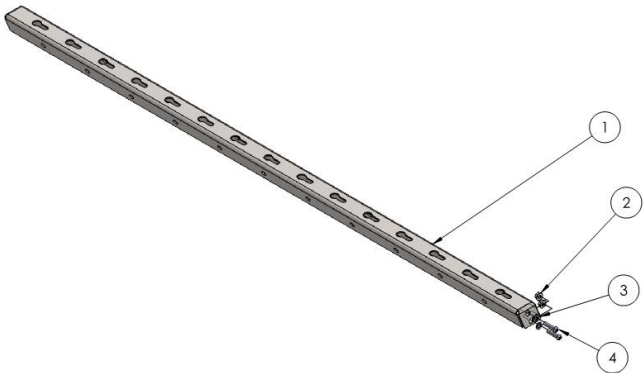

Additional long span rail kit t to suit short rack (AR-ASM11S) is same as Above with 03-0685 in lieu of 03-0659.

Components and parts

Contents if purchasing Jerry Can Mount Kit (AR-ASM10).

ITEM NO.	PART NUMBER	DESCRIPTION	QTY.
1	03-0669	AD RACK JERRY MOUNT BRKT	1
2	M8 WASHER	M8 WASHER	2
3	M8X25 BHCS	M8X25 BUTTON HEAD CAP SCREW	2
4	M8 FN	FLANGE NUT M8	2

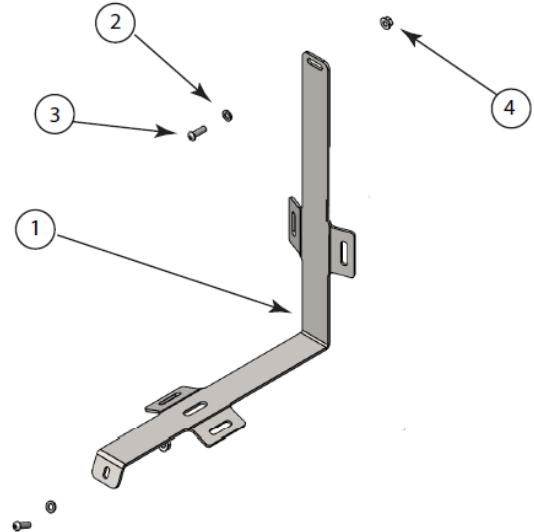

Maximum 2x Per side for Standard length Adventure Rack .

Maximum 1x per side for Short Adventure Rack.

Contents if purchasing Storage Box Kit (AR-ASM6).

ITEM NO.	PART NUMBER	DESCRIPTION	QTY.
1	03-0371	STORAGE BOX BRACKET	2
2	M8 WASHER	M8 WASHER	4
3	M8X25 BHCS	M8X25 BUTTON HEAD CAP SCREW	4
4	M8 FN	FLANGE NUT M8	4
5	trim cast box front open 550 x 360 x440	STORAGE BOX	1

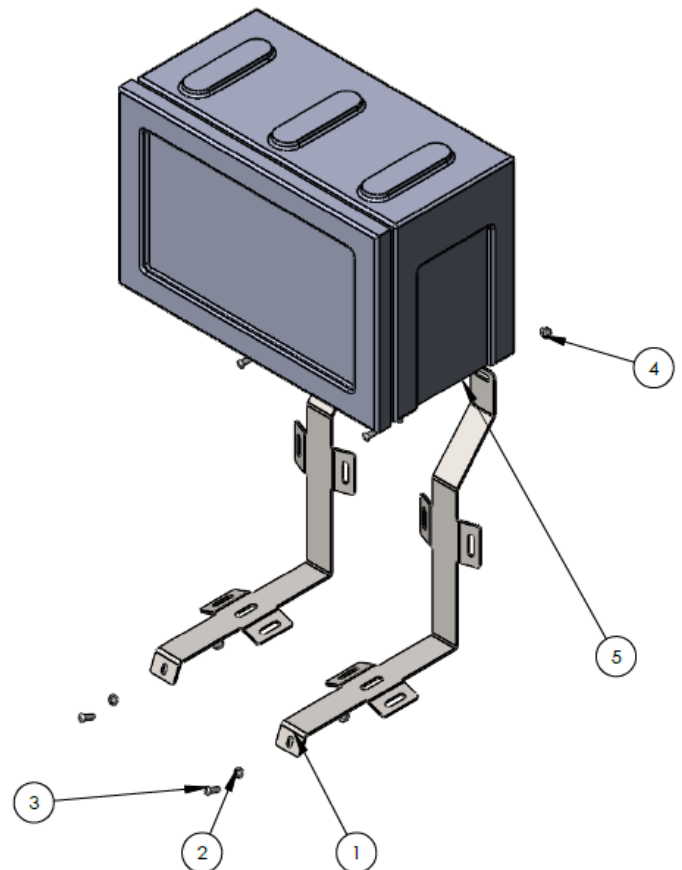

Maximum 2x Per side for Standard length Adventure Rack.

Maximum 1x per side for Short Adventure Rack.

Step 1

Unpack your Adventure rack and make sure everything that you ordered is there before beginning.

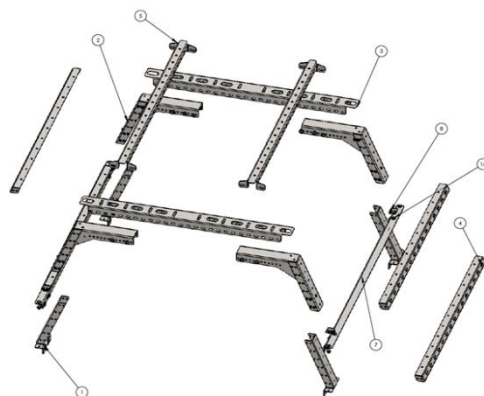

Step 2

Remove any tub lids and sports bars off tub.



Step 3

Assemble the Adventure Rack on the ground to the height you want. To do this you will need to use the M6 hardware in to connect the tub mounts to the Rack extensions. Leave bolts loose until the full rack is put together.

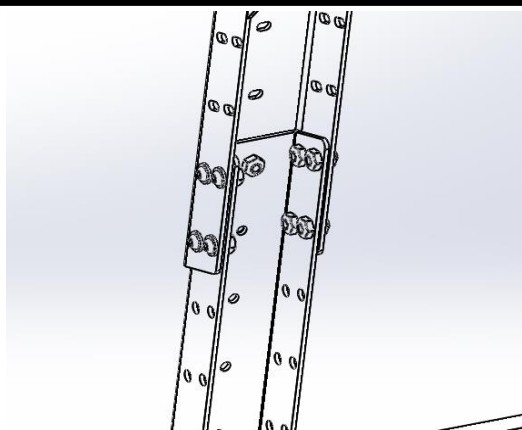

Step 4

Join each upright with the long span rail. Again, use M6 hardware. If mounting a long span rail below on to the tub mount you must use a rack spacer to fill the gap between the rail and the mount.

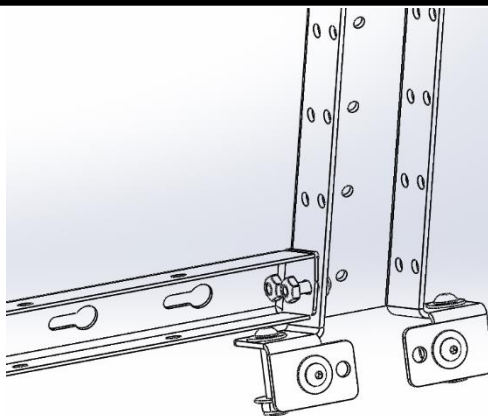

Step 5

Join the Rack top section to the Rack Extension using M8 hardware

Join the Rack top span connector to the top section with M8 hardware. You can position these 2 rails anywhere you like along the top.

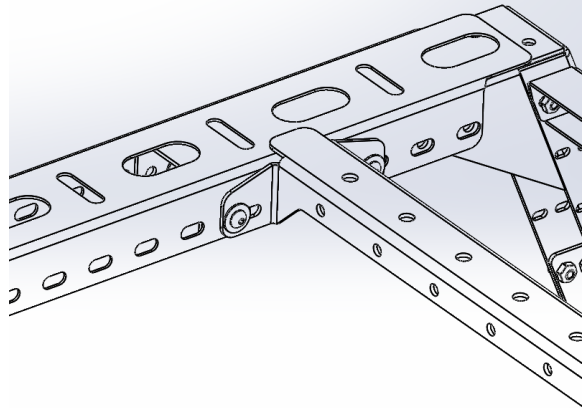

Step 6

Once the rack is put together you will need to lift it onto the tub with the help of a friend. Make sure you put the combing rail down first. Line up all the holes and clamp on to the tub with a soft clamp once you're happy with its position.

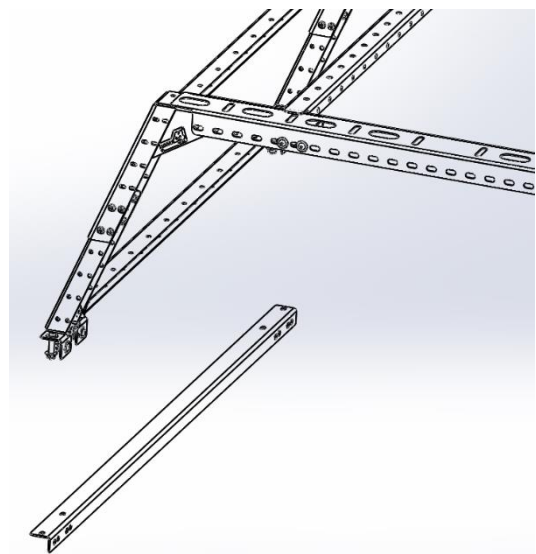

Step 7

If fitting to a Ranger or BT-50 use support plate as shown.

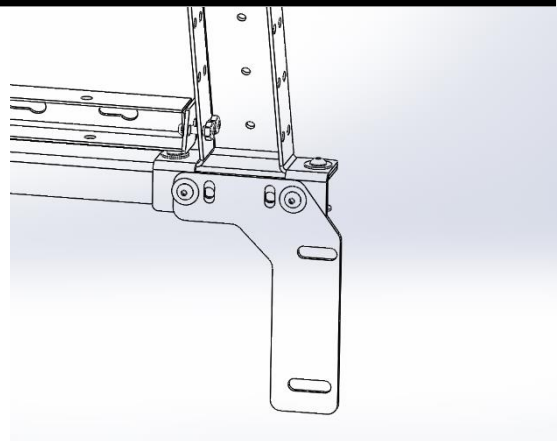

Step 8

Mark each hole with a centre punch. Remove the rack and drill through each hole with a 8.5mm or 9mm drill bit.



Step 9

Refit the rack with the help of a friend and use M8 hardware and torque down all bolts.



Step 10

If fitting shovel or axe mount, bolt directly to the side long span rails where you see fit using hardware supplied with mount.



Step 11

If fitting a 60" Hi Lift jack, bolt the foot section to tub mount.



Step 12

Fit Head section to other end with supplied hardware.

If fitting a 48" Hi Lift jack you will need to use an additional long span rail and bolt that close to another long span rail so they can both be used to take the head section

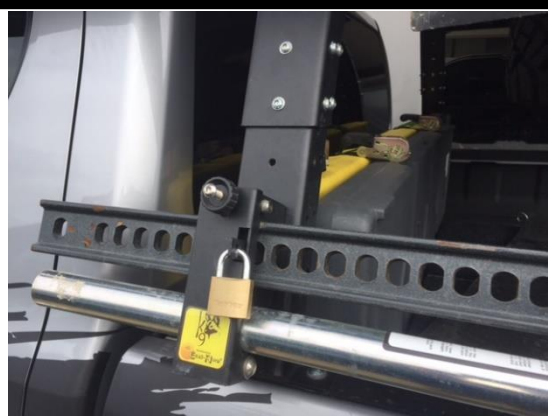

Step 13

If fitting to a Ford Ranger Wildtrack or to a vehicle with a Mountain Top roller shutter, you will use the roller shutter mounts as shown.

Insert supplied nut plates into channel in shutter assembly. Use bolt to aid maneuverability of plates.

Repeat for all feet.

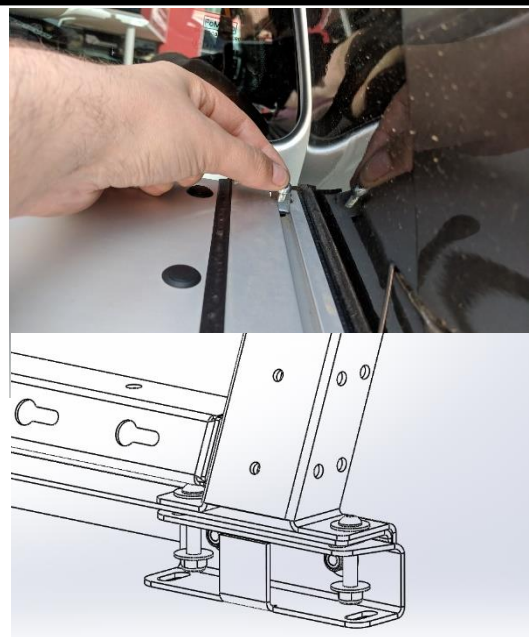

Step 14

If fitting the storage box, you will need to mount the support brackets as shown with M8 hardware.

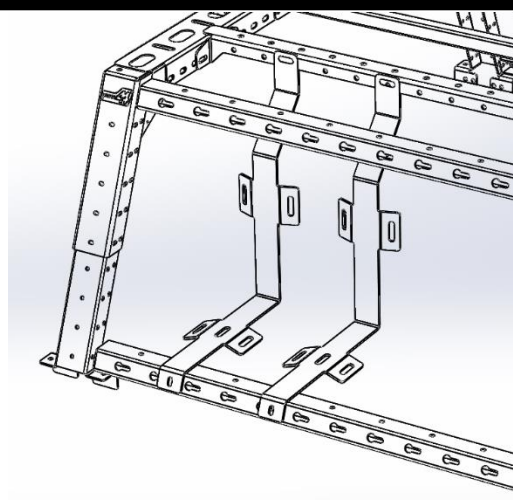

Step 15

Fit box on the brackets and secure with two ratchet straps (not included.) One underneath, and one around the back, and make sure you feed strap through slots.



Finished Product



Revised: 20/08/21

***Australia's Best
Off Road Products
Created... Not Cloned***

49-75 Pacific Drive, Keysborough, VIC, 3173

1300 806 952

www.uneek4x4.com.au

