

UNEK4
A U S T R A L I A
OFF ROAD ACCESSORIES

SKU: M-FB-BT50CEC-ASM0
M-FB-BT50CE-ASM0



Fitting Instructions

MAZDA BT50 2012-2020

Commander Bar

***Australia's Best Off Road Products
Created... Not Cloned***

Contents

WHY BUY UNEEK	3
IMPORTANT INFORMATION	4
COMPONENTS AND PARTS	5
CLASSIC (3 HOOP)	5
URBAN (SINGLE HOOP)	7
OPTIONAL EXTRA FR-RP-ASM0	9
OPTIONAL EXTRA FR-BP-11PX-ASM1	9
STEP 1	10
STEP 2	10
STEP 3	10
STEP 4	11
STEP 5	11
STEP 6	12
STEP 7	12
STEP 8	12
STEP 9	12
STEP 10	13
STEP 11	13
STEP 12	13
STEP 13	13
STEP 14	14
STEP 15	14
STEP 16	14
STEP 17	15
STEP 18	15
STEP 19	15
STEP 20	16
STEP 21	16
FINISHED PRODUCT	17

Why Buy Uneek

Australian Designed and Built

All our products are designed and manufactured right here in Australia, allowing us to have better lead times and better quality control than companies manufacturing overseas. By supporting us you are supporting to grow the Australian economy and our brand.

Uneek Styling

We do not design our bars to look the same across the vehicle range. We fully develop our own product to individually suit each vehicle. We take time in designing from scratch and then test all our bars to comply with all relevant ADRs and Australian Standards.

Lightweight Through Smart Engineering

Having a steel bar does not mean you have to add more weight than is required to the front of your vehicle. Our engineering practises ensure we have the right protection, designed the right way to ensure protection is at its maximum and weights at its minimum.

Proven Off Road

We take our products out and test them right here in the heart of our country in our Australian conditions so we know our products can withstand anything you throw at them.

Increased Approach Angles

Our bars are designed to give you the best advantage while off road, with increased approach angles means you can tackle those tough and steep angles better than you could with the original setup or other alternatives.

Warranty

Uneek 4x4 back itself as Australia's leading steel bull bar manufacturer. This is why we provide you with the best steel bar warranty in Australia - 5 years.

Important Information



PLEASE READ BEFORE INSTALLATION.

- When installed in accordance with these instructions, the front protection bar does not affect the operation of the vehicles SRS airbags.
- This product must be installed exactly as per these instructions using only hardware supplied.
- Take a few moments to read instructions thoroughly before beginning work.
- In the event of damage to any bar component please contact Uneek4x4 in regard to repair/replacement of components.
- Do not use this product for any vehicle make or model other than that specified on these instructions.
- Do not remove labels from this product.
- This product and its fixings must not be modified in any way unless stated in these fitting instructions.
- The installation of this product is recommended for trained personnel.
- These instructions are correct at time of publication. Uneek 4x4 cannot be held responsible for the impact of any changes subsequently made by the vehicle manufacturer.
- During installation it is the duty of the installer to check correct operation/clearances of all components.
- Supplied tow points are designed as tow points only. Use in a recovery operation will be at operator's risk.
- Installation time: 4-5 hours.
- Vehicle specific notes: A flip up license plate kit may be required. Optional Narva 90862 license plate light.



EYE & EAR PROTECTION REQUIRED



DRILLING REQUIRED



TWO PERSON LIFT REQUIRED



TORQUE SETTING



CUTTING OR GRINDING REQUIRED

FASTENER TORQUE SETTINGS:

M6 – 9Nm (4lb ft)

M8 – 22Nm (16lb ft)

M10 – 44Nm (32lb ft)

M12 – 77Nm (57lb ft)

TOOLS REQUIRED:

BASIC TOOL KIT: Soldering iron or electrical in-line connectors.

Male and female spade terminals.

Drill and drill bits up to 12mm.

Components and parts

CLASSIC (3 HOOP)

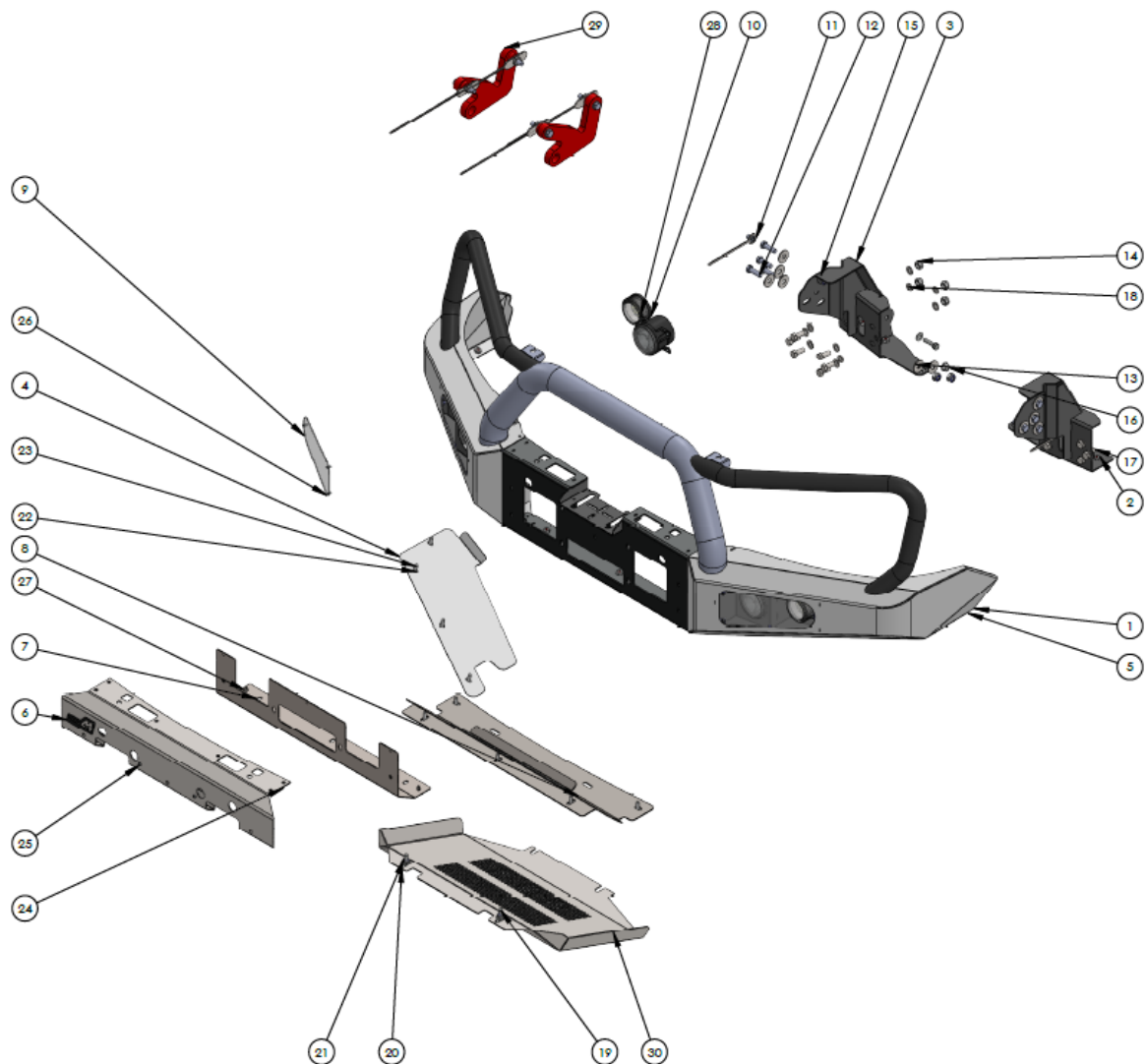

MAIN COMPONENTS

ITEM NO.	PART NUMBER	DESCRIPTION	Def ault /QT Y.
1	M-FB-BT50CEC-ASM1	MAZDA BT50 COMMANDER	1
2	03-0318L	IMPACT ASSY CRAWLER PX RANGER	1
3	03-0318R	IMPACT ASSY CRAWLER PX RANGER	1
4	09-0208R	MAZDA BT50 - UNDERWING PANEL RH	1
5	09-0208L	MAZDA BT50 WING UNDER PANEL	1
6	09-0124	PANELL ASSY TOP NP300	1
7	09-0126	PANEL MIDDLE CENTURY NP300	1
8	09-0210	INTERCOOLER PANEL ASY	1
9	12-0010	COVER PC FOG LIGHT	2
10	AUTO 8 LED	LED INDICATOR/PARKER	2

BOLT KIT

ITEM NO.	PART NUMBER	DESCRIPTION	Def ault /QT Y.
11	04-0086	ASSY M10 ROOT NUT PLATE	2
12	M12X40X1.75	M12 X 40 X 1.75 BOLT	8
13	M12 FW X 37	M12 FLAT WASHER LARGE	12
14	M12 NYLOC NUT	M12 NYLOC NUT	14
15	M12 HD WASHER	M12 HD WASHER	2
16	M12 X 1.75 FN	M12 FLANGE NUT	2
17	M12X30X1.75	BOLT M12 1.75 PITCH	12
18	M12 FW	M12 FLAT WASHER	20
19	M10X40X1.5	BOLT M10 X 40	4
20	M10FWX25	M10 FLAT WASHER X 25MM WIDE	6
21	M10 NYLOC	NYLOC SELF LOCKING NUT	2
22	M8 FW X 22	FLAT WASHER 8MM LARGE	13
23	M8X25 BHCS	M8X25 BUTTON HEAD CAP SCREW Z/P	13
24	M5X16 CS	M5 COUNTERSUNK SCREW	10
25	M5X15 PSCREW	M5 X 15 PH SCREW	5
26	M5X10 PSCREW	M5 X 10 PH SCREW	14
27	M5 FN	M5 FLANGE NUT	13

OPTIONAL COMPONENTS

ITEM NO.	PART NUMBER	DESCRIPTION	Def ault /QT Y.
28	CARWAY DRL	DRL FOG LIGHT	1
29	FR-RP-ASM0	FORD RANGER RECOVERY POINT	1
30	FR-BP-11PX-ASM1	Ranger bash plate	1

URBAN (SINGLE HOOP)

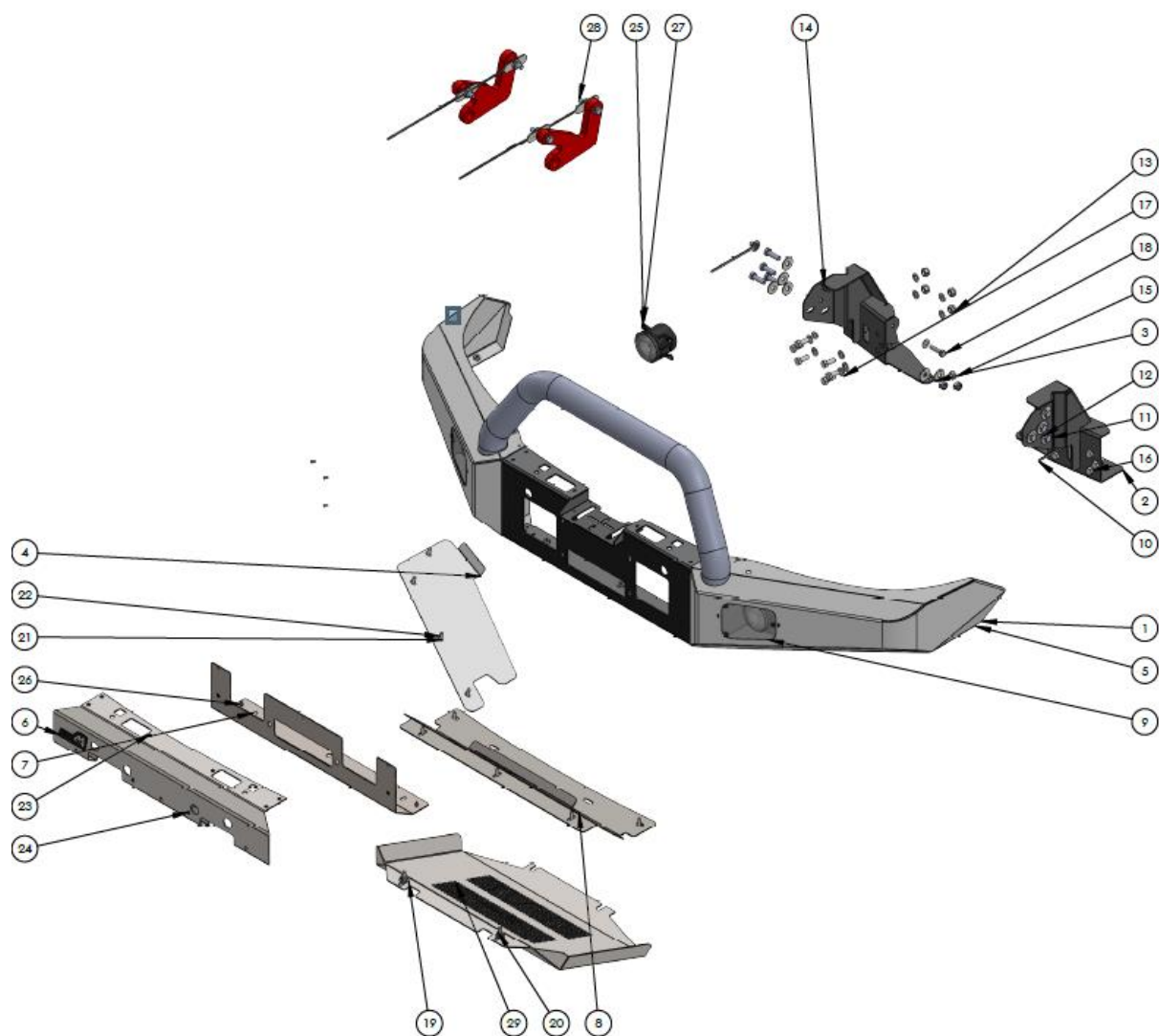

MAIN COMPONENTS

ITEM NO.	PART NUMBER	DESCRIPTION	Def ault /QT Y.
1	M-FB-BT50CE-ASM1	MAZDA BT50 COMMANDER URBAN	1
2	03-0318L	IMPACT ASSY CRAWLER PX RANGER	1
3	03-0318R	IMPACT ASSY CRAWLER PX RANGER	1
4	09-0208R	MAZDA BT50 - UNDERWING PANEL RH	1
5	09-0208L	MAZDA BT50 WING UNDER PANEL	1
6	09-0124	PANELL ASSY TOP NP300	1
7	09-0126	PANEL MIDDLE CENTURY NP300	1
8	09-0210	INTERCOOLER PANEL ASY	1
9	12-0026	COVER PC FOG LIGHT CENTURY	2

BOLT KIT

ITEM NO.	PART NUMBER	DESCRIPTION	Def ault /QT Y.
10	04-0086	ASSY M10 ROOT NUT PLATE	2
11	M12X40X1.75	M12 X 40 X 1.75 BOLT	8
12	M12 FW X 37	M12 FLAT WASHER LARGE	12
13	M12 NYLOC NUT	M12 NYLOC NUT	14
14	M12 HD WASHER	M12 HD WASHER	2
15	M12 X 1.75 FN	M12 FLANGE NUT	2
16	M12X30X1.75	BOLT M12 1.75 PITCH	12
17	M12 FW	M12 FLAT WASHER	20
18	M10X40X1.5	BOLT M10 X 40	4
19	M10FWX25	M10 FLAT WASHER X 25MM WIDE	6
20	M10 NYLOC	NYLOC SELF LOCKING NUT	2
21	M8 FW X 22	FLAT WASHER 8MM LARGE	13
22	M8X25 BHCS	M8X25 BUTTON HEAD CAP SCREW Z/P	13
23	M5X16 CS	M5 COUNTERSUNK SCREW	10
24	M5X15 PSCREW	M5 X 15 PH SCREW	5
25	M5X10 PSCREW	M5 X 10 PH SCREW	14
26	M5 FN	M5 FLANGE NUT	13

OPTIONAL COMPONENTS

ITEM NO.	PART NUMBER	DESCRIPTION	Def ault /QT Y.
27	CARWAY DRL	DRL FOG LIGHT	1
28	FR-RP-ASM0	FORD RANGER RECOVERY POINT	1
29	FR-BP-11PX-ASM1	Ranger bash plate	1

OPTIONAL EXTRA FR-RP-ASM0

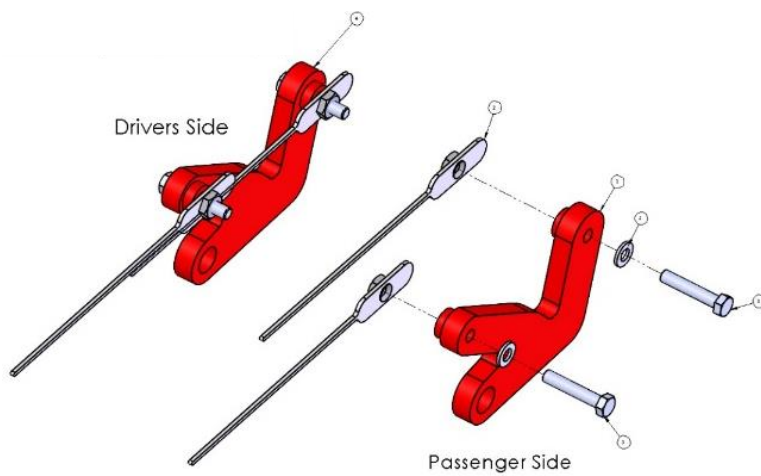

ITEM NO.	PART NUMBER	Description	QTY.
1	04-0248L	Recovery Plate ASSY Passenger Side	1
2	04-0252	NUT PLATE ASSY M12 RECOVERY	4
3	M12X65X1.75	M12 X 65MM X 1.75 BOLT	4
4	04-0248R	Recovery Plate Drivers Side	1
5	M12 HD WASHER	M12 HD WASHER	4

OPTIONAL EXTRA FR-BP-11PX-ASM1

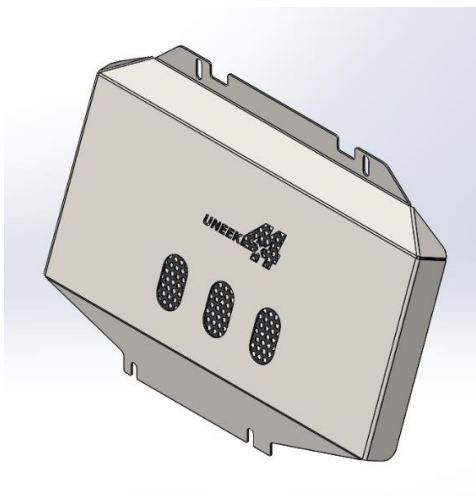

ITEM NO.	PART NUMBER	DESCRIPTION	QTY.
1	FR-BP-11PX-ASM1	Ranger bash plate	1

Step 1

Remove plastic panel above radiator, grille, and screws from inner guard. Unplug fog lights and remove four bolts from lower bumper support. Remove clips and bolts from top of bumper. Remove bumper cover. Remove steel bumper support and front bash plate. Retain bumper support bolts.



Step 2

Remove any plastic air deflectors near chassis rails. Remove bumper support brackets and if fitting to a triple hoop, remove headlights. Loosely fit impact absorbers to bar using original M10 bolts and supplied M12 hardware. Place captive nut plate through front of chassis and secure using hardware through side of chassis.



QTY	Description
8	M12 x 40 Bolt
16	M12 Flat Washer
8	M12 Nyloc
4	M10 Factory bolts
2	M10 x 30 Bolt
2	M10 Flat Washer

Step 3

Ensure the drivers side bracket is fitted to the drivers side of the car and vice versa.



Step 4

Passenger side is shown

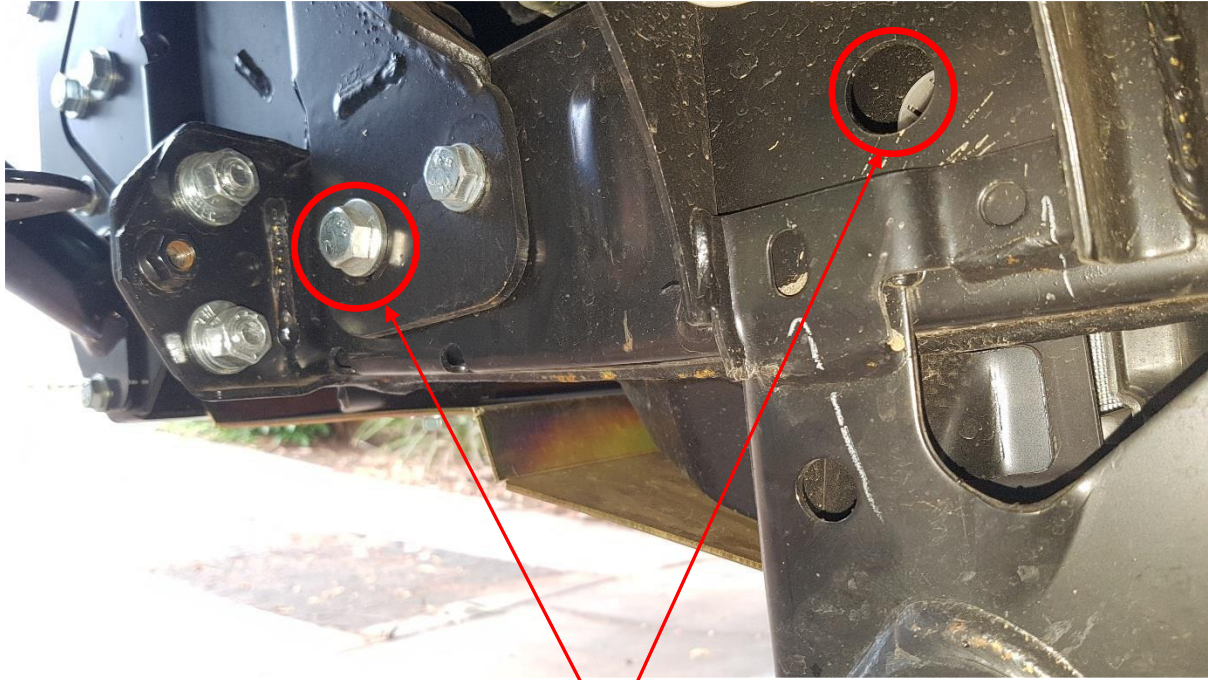

These holes in the frame are where the recovery points bolt through.

Step 5

When fitting the recovery points the smaller locating spacer must fit inside the holes in the chassis rail. The larger spacers sit on the frame and allow the recovery points clearance.

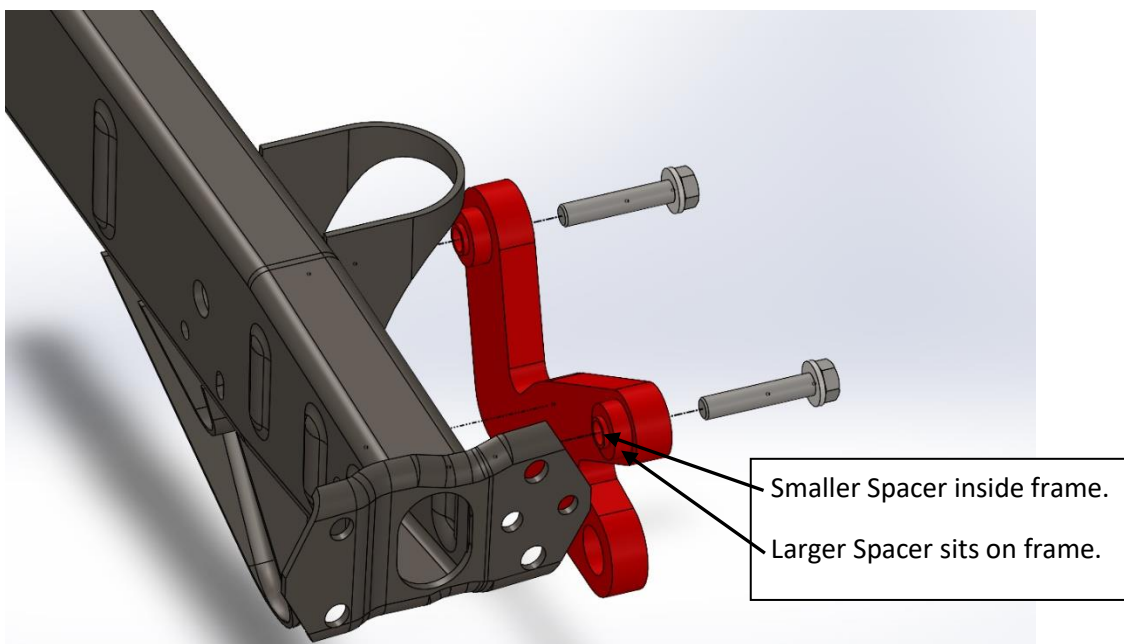

Step 6

M12 x 65 bolts go into M12 flat washer and then into the holes in chassis onto nut plates. The nut plates are inserted into the chassis rail. Ensure to snap off nut plate skewers when the bolts are torqued to the

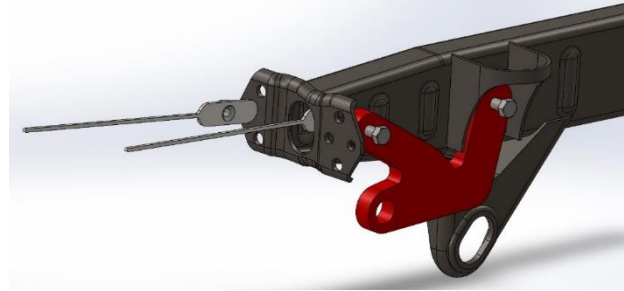

correct setting (77Nm).



M12-77Nm

Step 7

Repeat the Process for the Drivers side.

Ensure that the spacers fit inside the holes in chassis rails. Failure to do so may cause incorrect loading and part failure!

Step 8

If using factory fog light, remove from bumper. Fit fog light using M5 hardware. If fitting triple hoop bar, fit supplied indicators using supplied M5 hardware. If fitting to triple hoop, fit fog light covers using supplied M5 hardware.

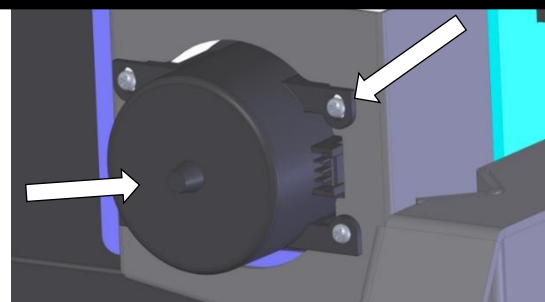

QTY	Description
8	M5 x 10 Phillips Head

Step 9

Install optional winch light and route cable to either side of bar. Run cable through access (arrow) hole.

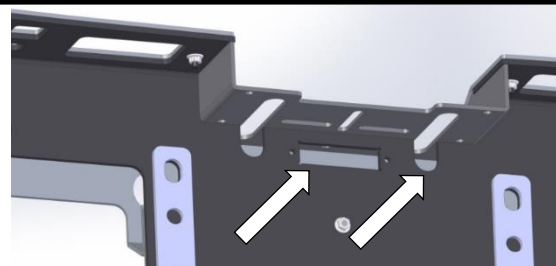

Step 10

Fit lower stainless panel to bar using M5 hardware.

QTY	Description
4	M5 Counter Sunk
4	M5 Flange Nut

M5 SCREW

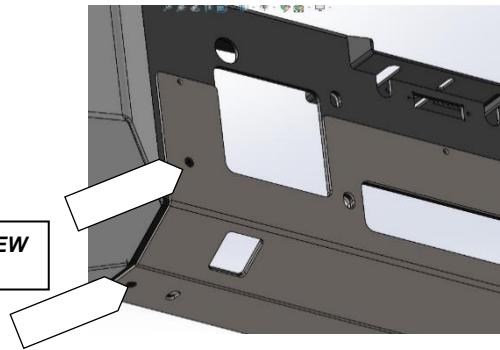

Step 11

Fit upper panel assembly using M5 hardware and 3 x M5 x 16 Phillips head screws through the front face of panel with flange nuts.

QTY	Description
6	M5 Counter Sunk
6	M5 Flange Nut
2	M5 Phillips Head
2	M5 Flange Nut

M5 x 16 PHILLIPS SCREW

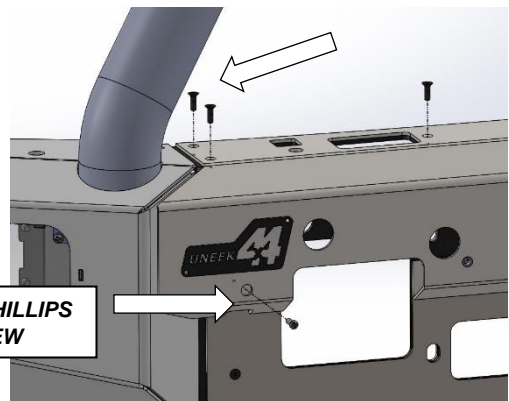

Step 12

Fit clear cover using M5 hardware.

QTY	Description
6	M5 Pan head screw

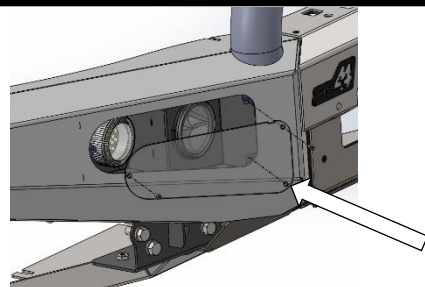

Step 13

Triple Hoop Only

Connect additional wires to indicator and park light to allow connection to indicator. Refit headlights.



Step 14

Use bumper cut template on bumper then continue the line horizontally. Refit bumper to vehicle.



Step 15

Cut lower center section of grille as per image. Refit grille.



Step 16

Fit the bar to vehicle using M12 hardware through slotted holes in mounts. Note Small M12 Heavy duty washer will be required for top inside position as large washer will not fit. Adjust bar for an even fit and **no less** than 10mm clearance to all body panels of bar. Tighten bolts just so bar does not move.



QTY	Description
6	M12 x 40 Bolt
10	M12 Flat Washer Large
2	M12 Flat Washer Heavy Duty
6	M12 Nyloc

Step 17

Locate the holes in the mounting brackets that are in the middle of all the mounting bolts. Drill a 12mm hole through the mounting web of the bulbar using this hole as a guide. Fit and tighten the M12 hardware to secure the position of the bar.

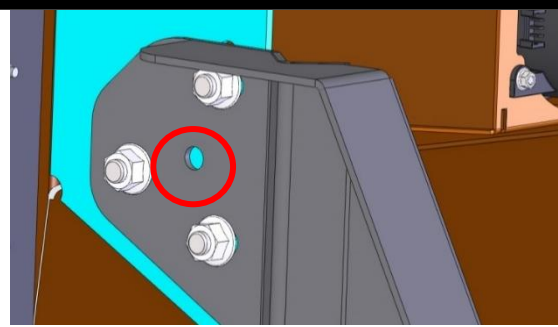

Note: The alignment of bar will be permanent once the bar has been pinned in this process.



QTY	Description
2	M12 x 40 Bolts
2	M12 x Flat Washers
2	M12 Flange Nuts

Step 18

Fit the winch to bar making sure the clutch handle is facing forward with the winch mounting points. Fit control box to recess in bar.

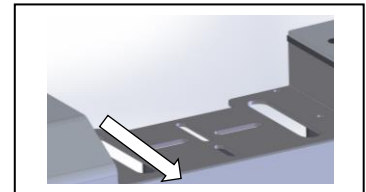

Step 19

Connect fog lights and indicators if applicable.



Step 20

Attach outer wing guards using hardware. Mark a line across plastic inner guard and cut with the same profile as the guard. Flip plastic panel over guard lip when complete.

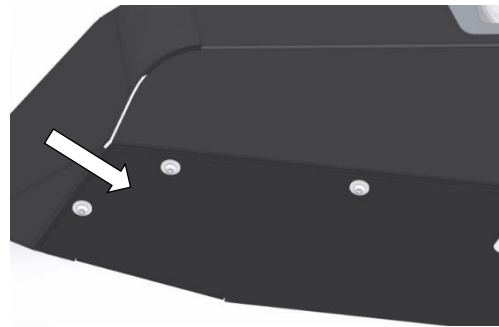

QTY	Description
8	M8 x 25 Button Head Cap Screw
8	M8 Flat Washer

Step 21

Fit center panel using hardware. Place M10 hardware in the center lower holes as shown. Refit bash plate and radiator panel. Clean bar with a soft rag when complete.

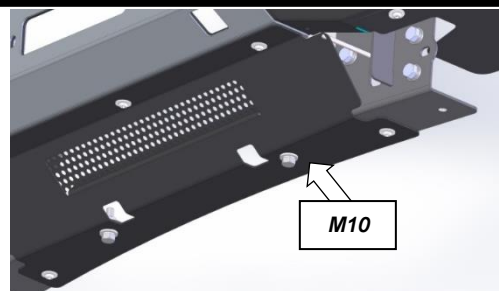

QTY	Description
5	M8 x 25 Button Head Cap Screw
5	M8 Flat Washer
2	M10 x 40 Bolt
2	M10 x 27 Flat Washer
2	M10 Nyloc

Finished Product



Revised: 29/07/2021

***Australia's Best
Off Road Products
Created... Not Cloned***

20 Gateway Drive, Carrum Downs, VIC, 3201

1300 806 952

www.uneek4x4.com.au

