

UNEEK4
AUSTRALIA
OFF ROAD ACCESSORIES

SKU: BE-XX-ASM0



Fitting Instructions
Bed Extender
Universal

***Australia's Best Off Road Products
Created... Not Cloned***

Contents

WHY BUY UNEEK	3
IMPORTANT INFORMATION	4
COMPONENTS AND PARTS	5
STEP 1	6
STEP 2	6
STEP 3	6
STEP 4	6
STEP 5	7
STEP 6	7
STEP 7	7
STEP 8	7
STEP 9	8
STEP 10	8
STEP 11	8
STEP 12	8
STEP 13	9
STEP 14	9
STEP 15	9
STEP 16	10
STEP 17	10
FINISHED PRODUCT	11

Why Buy Uneek

Australian Designed and Built

All our products are designed and manufactured right here in Australia, allowing us to have better lead times and better quality control than companies manufacturing overseas. By supporting us you're supporting to grow the Australian economy and our brand.

Uneek Styling

We do not design our bars to look the same across the vehicle range. We fully develop our own product to individually suit each vehicle. We take time in designing from scratch and then test all our bars to comply with all relevant ADRs and Australian Standards.

Lightweight Through Smart Engineering

Having a steel bar doesn't mean you have to add more weight than is required to the front of your vehicle. Our engineering practises ensure we have the right protection, designed the right way to ensure protection is at its maximum and weights at its minimum.

Proven Off Road

We take our products out and test them right here in the heart of our country in our Australian conditions so we know our products can withstand anything you throw at them.

Increased Approach Angles

Our bars are designed to give you the best advantage while off road, with increased approach angles means you can tackle those tough and steep angles better than you could with the original setup or other alternatives.

Warranty

Uneek 4x4 back itself as Australia's leading steel bull bar manufacturer. This is why we provide you with the best steel bar warranty in Australia - 5 years.

Important Information



PLEASE READ BEFORE INSTALLATION.

- The Ute bed extender is a dual purpose device that allows you to have a longer secure bed area as well as having a purposeful cargo divider.
- With your Bed Extender flipped out you must use supplied tie down strap to prevent Bed Extender bouncing up and down.
- The Uneek Ute Bed extender is made from all metal construction to allow a long life of hard abuse. Feel free to use the Bed Extender as a bench when not installed in the vehicle. The tubes are made from aluminium and do not need any maintenance. The joining brackets are made from powder coated steel.
- Always ensure your rear number plate is visible when your tailgate is down.
- You must first assemble your Bed Extender prior to installing the swivel brackets
- If you plan to fit a motor bike to the bed using the bed extender you may need our tiered brackets (optional extra) to tier the tubes out to clear the rear wheel of the bike.
- Installation time is estimated at 15-25min after assembly with 30min for assembly.

FASTENER TORQUE SETTINGS:

M6 – 9Nm (4lb ft)
M8 – 22Nm (16lb ft)
M10 – 44Nm (32lb ft)
M12 – 77Nm (57lb ft)

TOOLS REQUIRED:

Hand Spanners and Socket set

Alan Keys

Power drill and 8mm or (5/16") driver bit

Tape measurer

Components and parts

ITEM	PART NUMBER	Description	QTY
1	BE-3R	SIDE MOUNT RH	1
2	41005	DEE BEE MINI	4
3	BE-NN-4	END SUPT	2
4	BE-4	TILT PIN	2
5	M12 NYLOC	NYLOC SELF LOCKING NUT, ST STL A2 ISO	2
6	BE-2	JOINER	2
7	BE-NN-ASM1	RAIL WELDMENT	3
8	E4-34	25NB CLAMP	6
9	BE-3	SIDE MOUNT RH	1
10	M8 NYLOC	NYLOC SELF LOCKING NUT, ST STL A2 ISO	12
11	M8X25 BHCS	M8X25 BUTTON HEAD CAP SCREW Z/P	12
12	M8 WASHER	M8 WASHER	18
13	M8 SPRING WASHER	M8 SPRING WASHER	6
14	M8 X 30	M8 X 30 HEX BOLT 8.8 Z/P	6
15	M6 X 25 CSK	M6 x 25 csk machine screw	4
16	m6 nut	M6 nut z/p	4
17	m6 washer	m6 washer	4
18	S14.8x16mm	Sheet metal screw	8
19	TS10- Roof rack cam buckle	25mm x 1.5m strap and buckle	1
20	AP25	ANCHOR PLATE	1
21	SHIPPER 1460 X 620 X 75	CARTON 1460 X 620 X 75	1
22	BE-FI	FITTING INSTRUCTIONS	1

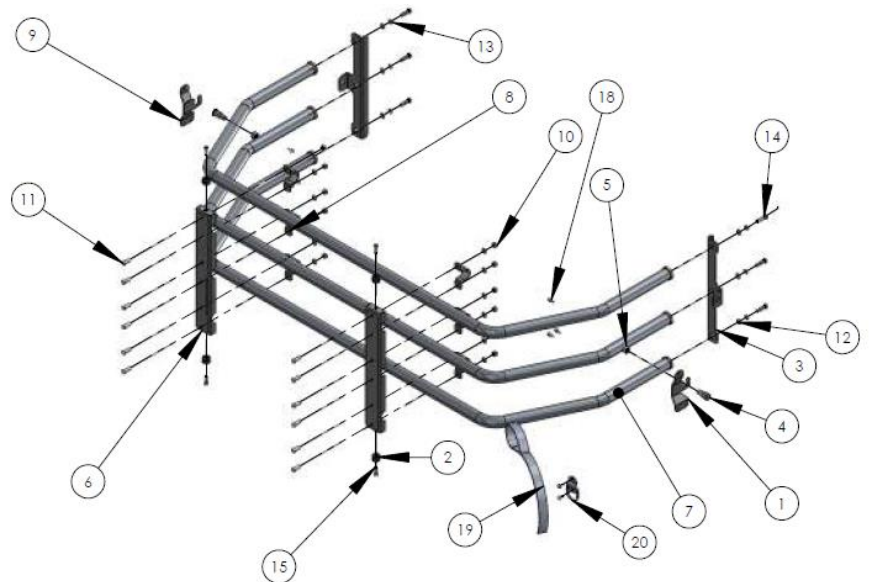

Step 1

Unpack your Bed Extender and ensure all items are accounted for.



Step 2

With the tubes standing up fit the joiner over the set of tubes.



Step 3

Using M8 button head cap screw secure tubes with tube clamps. Ensure a washer and nyloc nut are used on the inside.



Step 4

Ensure clamps are loosely fitted.



Step 5

Turn the Bed Extender on its back and loosely fit end supports with M8 Hex bolts, washer and spring washer.



Step 6

Now finish off fitting all the tube clamps. These clamps do not need to be done up too tight. Generally a gap of 5mm between the joiner and the tube clamp is what you're aiming for.



Step 7

Fit tilt pins and M12 nyloc nuts.

Use a 19mm spanner on the nyloc nut and a 13mm spanner on the tilt pin. Ensure the flats of the tilt pin are parallel to the tubes.



Step 8

Torque up each bolt on the end supports. It is best to adjust the end supports to make the bed extender as narrow as possible. Once fitting to the vehicle you can then widen them as required.



Step 9

Fit a rubber stopper to each joiner end. Push the M6 counter sunk screw in as far as it will go. On the inside of the joiner you will need to push hard to get the washer and nut on.



Step 10

Repeat step 9 for the other 3 rubber stoppers.



Step 11

Your Bed Extender is now assembled. Measure the width of the outside tilt pins and adjust as required to ensure it will fit inside your bed.



Step 12

Position the Bed Extender with swivel bracket inside the back of the ute with the tail gate closed. You may need to adjust the tubes on the support brackets for a good fit. Leave about 20mm gap between the Bed Extender and the edge of the tail gate.

Nissan Navara D40 shown here, other vehicles use the same principle.



Step 13

With the tailgate open raise the swivel bracket up until the Bed Extender tubes look parallel to the ground. Then mark the holes for the swivel bracket.

Some models have a different looking swivel bracket but it should still be mounted the same.



Step 14

Drive in sheet metal screws into the bed of the truck. Repeat for the other side.

For heavy use we suggest replacing the self tapping screws with nuts and bolts. Access can be gained behind the tail lamp.



Step 15

Lift Bed Extender into the ute and with the Bed Extender straight up in the air, feeding the tilt pins into the swivel brackets.

Test flipping the bed extender forward and backward.

Ensure the tailgate closes with the bed extender flipped in.



Step 16

Fit the anchor point on the tail gate away from any bolts, cables or flip brackets.

Drive in with sheet metal screws.

Keep your tie down strap to secure Bed Extender to this point when flipped out.



Step 17

Don't forget to tie down the Bed Extender when using in the flipped out orientation.

Enjoy the extra space.



Finished Product



Revised: 22/07/2019

***Australia's Best
Off Road Products
Created... Not Cloned***

49-75 Pacific Drive, Keysborough, VIC, 3173

1300 806 952

www.uneek4x4.com.au

