

**UNEK44**  
AUSTRALIA  
OFF ROAD ACCESSORIES

**SKU: FR-S-PX-ASM0**



## ***Fitting Instructions***

***Ford Ranger 11-21 / Mazda BT50 11-19***

***Sliders - Dual Cab & Extra Cab Models***

***Australia's Best Off Road Products  
Created... Not Cloned***

# **Contents**

---

<b>WHY UNEEK</b>	<b>3</b>
<b>IMPORTANT INFORMATION</b>	<b>4</b>
<b>COMPONENTS AND PART</b>	<b>5</b>
<b>STEP 1</b>	<b>6</b>
<b>STEP 2</b>	<b>6</b>
<b>STEP 3</b>	<b>6</b>
<b>STEP 4</b>	<b>6</b>
<b>STEP 5</b>	<b>7</b>
<b>STEP 6</b>	<b>7</b>
<b>STEP 7</b>	<b>7</b>
<b>STEP 8</b>	<b>7</b>
<b>FINISHED PRODUCT</b>	<b>8</b>

# ***Why Uneek***

---

## ***Australian Designed and Built***

All our products are designed and manufactured right here in Australia, allowing us to have better lead times and better quality control than companies manufacturing overseas. By supporting us you're supporting to grow the Australian economy and our brand.

## ***Uneek Styling***

We do not design our bars to look the same across the vehicle range. We fully develop our own product to individually suit each vehicle. We take time in designing from scratch and then test all our bars to comply with all relevant ADRs and Australian Standards.

## ***Lightweight Through Smart Engineering***

Having a steel bar doesn't mean you have to add more weight than is required to the front of your vehicle. Our engineering practises ensure we have the right protection, designed the right way to ensure protection is at its maximum and weights at its minimum.

## ***Proven Off Road***

We take our products out and test them right here in the heart of our country in our Australian conditions so we know our products can withstand anything you throw at them.

## ***Increased Approach Angles***

Our bars are designed to give you the best advantage while off road, with increased approach angles means you can tackle those tough and steep angles better than you could with the original setup or other alternatives.

## ***Warranty***

Uneek 4x4 back itself as Australia's leading steel bull bar manufacturer. This is why we provide you with the best steel bar warranty in Australia - 5 years.

# Important Information

---



**PLEASE READ BEFORE INSTALLATION.**

- When installed in accordance with these instructions rock sliders do not affect the operation of the vehicles SRS airbags.
- This product must be installed exactly as per these instructions using only hardware supplied.
- Take a few moments to read instructions thoroughly before beginning work.
- In the event of damage to any bar component please contact Uneek 4x4 in regards to repair/replacement of components.
- Do not use this product for any vehicle make or model other than that specified on these instructions.
- Do not remove labels from this product.
- This product and its fixings must not be modified in any way unless stated in these fitting instructions.
- The installation of this product is recommended for trained personnel.
- These instructions are correct at time of publication. Uneek 4x4 cannot be held responsible for the impact of any changes subsequently made by the vehicle manufacturer.
- During installation it is the duty of the installer to check correct operation/clearances of all components.
- Installation time: 1 hour.
- Vehicle specific notes: A hydraulic jack will be required. Please note that the threads in the captive nut end plates are 1.5 pitch.



**EYE & EAR PROTECTION REQUIRED**



**DRILLING REQUIRED**



**TWO PERSON LIFT REQUIRED**



**TORQUE SETTING**



**CUTTING OR GRINDING REQUIRED**

---

**FASTENER TORQUE SETTINGS:**

M6 – 9Nm (4lb ft)

M8 – 22Nm (16lb ft)

M10 – 44Nm (32lb ft)

M12 – 77Nm (57lb ft)

**TOOLS REQUIRED:**

Basic tool kit: Hydraulic jack, 'G' or 'F' clamp, drill and 10mm drill bit, sharp Stanley knife.

# Components and part

ITEM NO.	PART NUMBER	DESCRIPTION	QTY.
1	FR-S-PX(OR PXEC)-ASM1R	SLIDER WELDED ASSY PX RANGER	1
2	FR-S-PX(OR PX EC)-ASM1L	SLIDER WELDED ASSY PX RANGER	1
3	03-0150R	BRACKET ASSY REAR BRACE PX RANGER SLIDER	1
4	03-0149R	BRACKET ASSY INNER CHASSIS PX RANGER SLIDER	1
5	03-0150L	BRACKET ASSY REAR BRACE PX RANGER SLIDER	1
6	03-0149L	BRACKET ASSY INNER CHASSIS PX RANGER SLIDER	1
7	05-0086	TUBE CRUSH PX RANGER SLIDER	4
8	04-0113	PLATE NUT ASSY PX RANGER SLIDERS	8
9	09-0028	PANEL TREAD SLIDER HILUX 05	2
10	M12 FW X 37	M12 FLAT WASHER X 37	4
11	M12 SW	M12 SPRING WASHER	4
12	M10X40X1.5	BOLT M10 X 40	8
13	M12X130X1.75	M12 X 130MM X 1.75 BOLT	2
14	M12X120X1.75	M12 X 120MM X 1.75 BOLT	2
15	M10X30	M10 X 1.5 X 30MM BOLT	12
16	M10FWX25	M10 FLAT WASHER X 25MM WIDE	24
17	M10SW	M10 SPRING WASHER	20
18	M10X1.5N	M10 X 1.5 NUT	4
19	M6X16 BHCS	M6 BUTTON HEAD CAP SCREW	16
20	M6 FN	FLANGE NUT M6	16

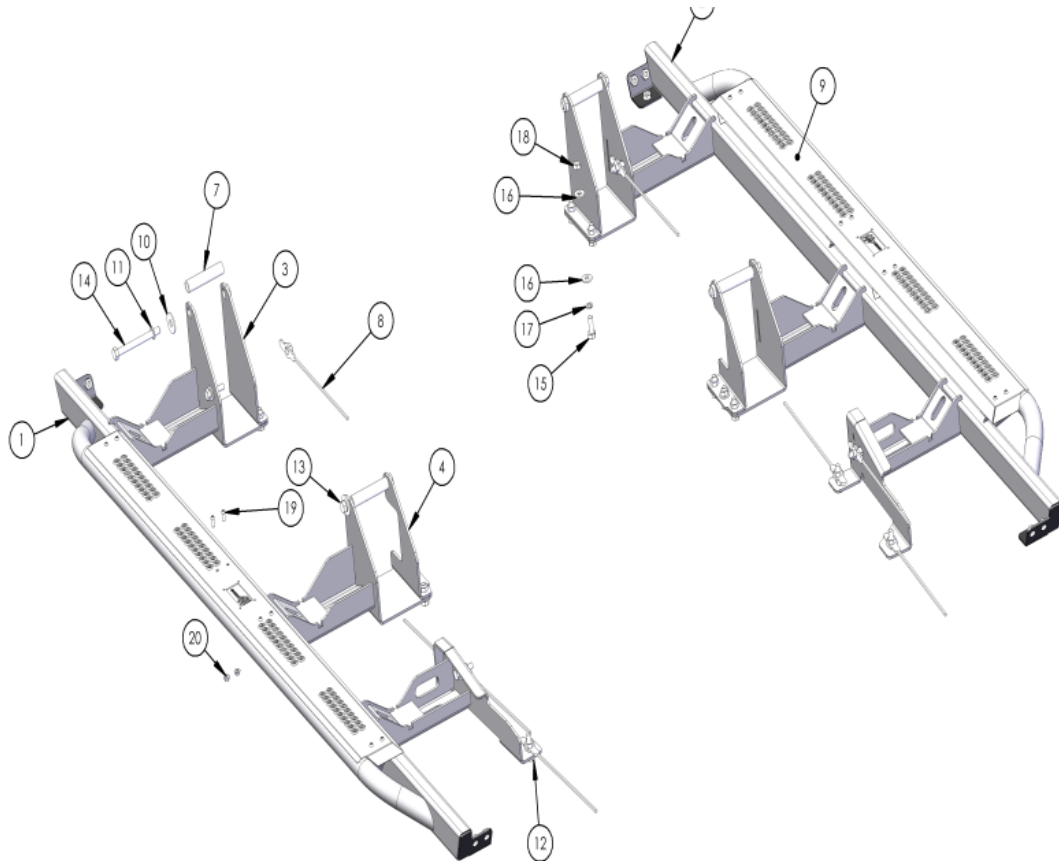

## Step 1

Remove original steps and brackets if fitted. Place the bolts removed back into the vehicle body. Fit the tread plate sections to the sliders using M6 button head cap screws and M6 flange nuts.



M6-9Nm

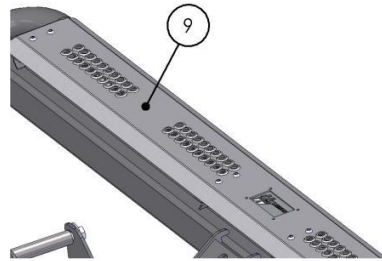

## Step 2

Prepare M12 x 120 and 130 long bolts with an M12 spring washer and M12 flat washer. The 120 is on the rearmost mount and 130 in the middle mount. With the help of another person and or hydraulic jack lift steps into position Keeping bolts in a position shown to fit over the top of the chassis rails.

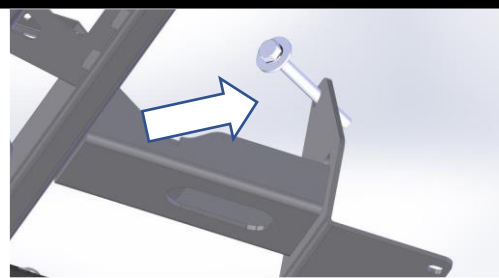

## Step 3

Place spacer tube over M12 bolt. Loosely fit middle inner chassis bracket to slider screwing in the M12 bolt first. Secure lower points using M10 bolts, spring washers and flat washers. Leave finger tight. **NOTE: When it is time to fully tighten us a large F clamp or G clamp to hold inner mounts hard up against chassis rails.**



## Step 4

Align mount holes in front bracket to corresponding ones in the chassis.

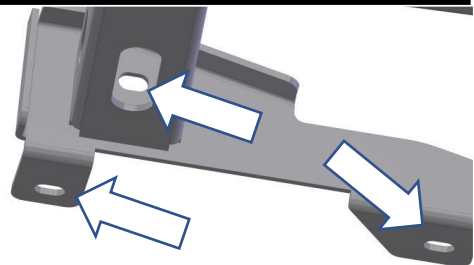



## Step 5

When the front mount is aligned it may be required to trim some of the plastic guard away from the fuel tank. Use extreme care when cutting with a Stanley knife. Fit rear inner mount bracket again starting with the top M12 bolt then lower M10 bolts, spring washers and flat washers. NOTE: Fuel lines may have to be manipulated to clear.

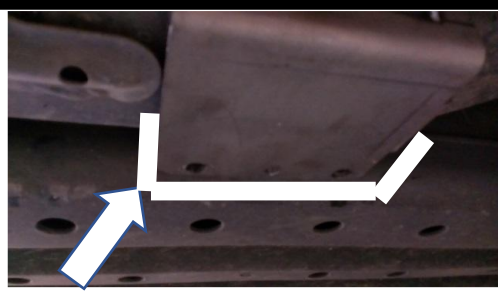

## Step 6

Start fitting internal nut plates into chassis and secure to mounts using M10 x 40 bolts, spring washers and flat washers. Bend plate arms as needed using pliers. Refer to image. Try to use holes closest to mounting points.



## Step 7

When done adjust slider into a position that is even on the vehicle. Start tightening mounting bolts.



M10-44Nm M12-77Nm

## Step 8

When rail is positioned correctly and bolts are secure move onto the pinning procedure. Drill centre point out to 10mm. Secure Using M10 x 30 bolt, spring washer, two flat washers and an M10 nut. Check that fuel lines and brake lines are not rubbing.



10MM



M10-44Nm

# ***Finished Product***

---





Revised: 22/08/2019

***Australia's Best  
Off Road Products  
Created... Not Cloned***

20 Gateway Drive, Carrum Downs, VIC, 3201

1800 806 952

[www.uneek4x4.com.au](http://www.uneek4x4.com.au)

