

UNEK44
AUSTRALIA
OFF ROAD ACCESSORIES

SKU: JK-ST-ASM0



Fitting Instructions

Jeep JK Wrangler

Storage Tub

***Australia's Best Off Road Products
Created... Not Cloned***

Contents

| | |
|------------------------------|-----------|
| WHY BUY UNEEK | 3 |
| IMPORTANT INFORMATION | 4 |
| COMPONENTS AND PARTS | 5 |
| STEP 1 | 6 |
| STEP 2 | 6 |
| STEP 3 | 6 |
| STEP 4 | 6 |
| STEP 5 | 7 |
| STEP 6 | 7 |
| STEP 7 | 7 |
| STEP 8 | 7 |
| STEP 9 | 8 |
| STEP 10 | 8 |
| STEP 11 | 8 |
| STEP 12 | 8 |
| STEP 13 | 9 |
| FINISHED PRODUCT | 10 |

Why Uneek

Australian Designed and Built

All our products are designed and manufactured right here in Australia, allowing us to have better lead times and better quality control than companies manufacturing overseas. By supporting us you're supporting to grow the Australian economy and our brand.

Uneek Styling

We do not design our bars to look the same across the vehicle range. We fully develop our own product to individually suit each vehicle. We take time in designing from scratch and then test all our bars to comply with all relevant ADRs and Australian Standards.

Lightweight Through Smart Engineering

Having a steel bar doesn't mean you have to add more weight than is required to the front of your vehicle. Our engineering practises ensure we have the right protection, designed the right way to ensure protection is at its maximum and weights at its minimum.

Proven Off Road

We take our products out and test them right here in the heart of our country in our Australian conditions so we know our products can withstand anything you throw at them.

Increased Approach Angles

Our bars are designed to give you the best advantage while off road, with increased approach angles means you can tackle those tough and steep angles better than you could with the original setup or other alternatives.

Warranty

Uneek 4x4 back itself as Australia's leading steel bull bar manufacturer. This is why we provide you with the best steel bar warranty in Australia - 5 years.

Important Information



PLEASE READ BEFORE INSTALLATION.

- This product must be installed exactly as per these instructions using only hardware supplied.
- Take a few moments to read instructions thoroughly before beginning work.
- In the event of damage to any bar component please contact Uneek 4x4 in regards to repair/replacement of components.
- This product and its fixings must not be modified in any way unless stated in these fitting instructions.
- The installation of this product is recommended for trained personnel.
- These instructions are correct at time of publication. Uneek 4x4 cannot be held responsible for the impact of any changes subsequently made by the vehicle manufacturer.
- During installation it is the duty of the installer to check correct operation/clearances of all components.
- Installation time: 3-4 hours
- Vehicle specific notes: The D31A Optima battery found in Diesel JK Wranglers was used for clamp and alignment in this storage tub. Other batteries will fit but you should test fit them first.



EYE & EAR PROTECTION REQUIRED



DRILLING REQUIRED



TWO PERSON LIFT REQUIRED



TORQUE SETTING



CUTTING OR GRINDING REQUIRED

FASTENER TORQUE SETTINGS:

M6 – 9Nm (4lb ft)

M8 – 22Nm (16lb ft)

M10 – 44Nm (32lb ft)

M12 – 77Nm (57lb ft)

TOOLS REQUIRED:

Power drill with drill bits, hand spanners and socket sets, Allan keys, angle grinder, Utility knife, tape measurer, pliers and vice grips and nutsert gun with m6 attachments (can be used to speed up install, not mandatory).

Components and parts

| Part No | Description | Qty |
|------------------|--|-----|
| FAS-M6-30-SS-CS | M6 X 30 BUTTON HEAD CAP SCREW COUNTER SUNK | 14 |
| FAS-M6-FW | M6 FLAT WASHER | 14 |
| FAS-M8-60-HX-8.8 | M8 X 60 HEX BOLT, 8.8 ZP | 2 |
| FAS-M8-FW | M8 FLAT WASHER | 2 |
| FAS-M6-NY | M6 NYLOC NUT | 14 |
| FAS-M6-NS | M6 NUTSERT | 8 |
| HPO732 | CABLE GLAND 6-12MM | 2 |
| 9231D | GROMMET BLIND 22MM | 3 |
| TCF087 | REO BAR | 2 |
| TCF088 | BATTERY CLAMP | 1 |

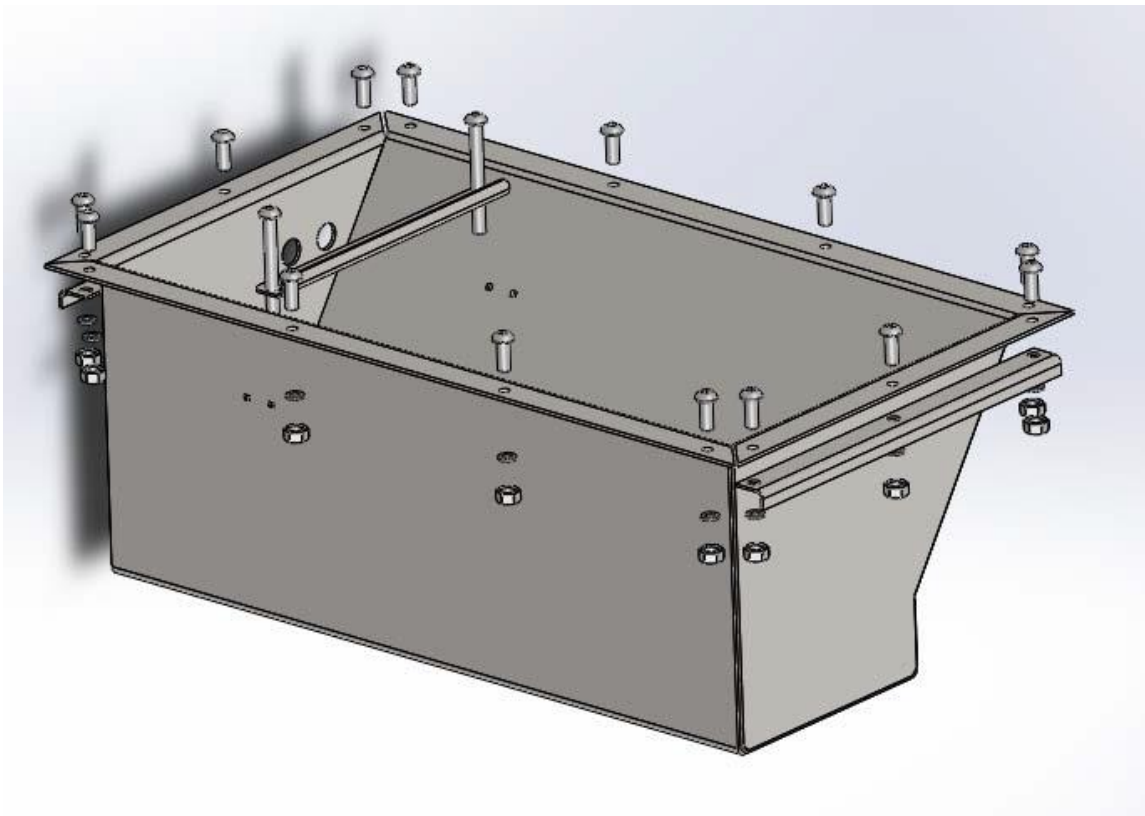

Step 1

Empty out your factory storage compartment and remove the top cover (this will be re-used) and subwoofer.



Step 2

Remove all carpet above and remove the exhaust muffler underneath.



Step 3

Cut out a cardboard square the same dimensions as the outer dimensions of the box not counting the extended lip. 625mm x 330mm.



Step 4

Mark a line in the middle of the factory storage compartment and a line in the middle of the cardboard cut out. Match up these lines to centralize the cut out.



Step 5

From the edge of the rubber measure 168mm in. Mark a line and this will be the edge of the cardboard cut out. Trace a line all the way around the cardboard cut out and remove the cardboard.



Step 6

With safety glasses and ear protection on cut out the floor as per the lines marked with an angle grinder. Notice the rear sway bar underneath. The new tub will fit right up next to it.



Step 7

The edge of your cardboard cut out does not fit all the way to the flat at the sides. This is so your new storage tub does not hit your shock mount towers. You will need to fold up these edges with pliers to create a new flat surface for the tub to mount on. Cut a small slit up towards the side of the vehicle to allow this edge to be folded up.



Step 8

Once the edges have been folded up drill a small hole at the edge of the slits to stop a crack propagating. Trim the distance between each flap to match the tub (625mm).



Step 9

To ensure your new tub sits flat you will need to trim the raised sheet metal edges and fold them down.



Step 10

Test fit in the new storage tub in the cut out ensuring everything clears. Trim more sheet metal if required. Ensure the storage tub is about 2-4 mm away from the sway bar underneath. Mark each hole from above then remove the storage box for drilling. You can use bolts and nuts in all positions but we highly recommend using a nutsert on all holes besides the sides as fitting a nut from underneath is very difficult. Possible but difficult. Remove storage tub and drill holes for clearance for either nutserts or M6 bolts.



Step 11

Use a liberal amount of adhesive sealant around the edge of the cut out. Place storage tub in before sealant sets.



Step 12

Torque up each counter sunk screw. Use support brackets Reo bars under the floor on the sides. Trim carpet to suit and your finished. Make sure you get a new muffler fitted at an exhaust shop.



Step 13

If fitting a battery use clamps and bolts supplied to clamp down battery to tub. Feed battery cables through supplied cable glands.



Finished Product



Revised: 27/08/2019

***Australia's Best
Off Road Products
Created... Not Cloned***

20 Gateway Drive, Carrum Downs, VIC, 3201

1800 806 952

www.uneek4x4.com.au

