

**UNEEK4x4**  
AUSTRALIA  
OFF ROAD ACCESSORIES

**SKU: JK-FB-M-ASM0**



## ***Fitting Instructions***

***Jeep JK Wrangler 2007 - 2014***

***Modular Bull Bar***

***Australia's Best Off Road Products  
Created... Not Cloned***

# **Contents**

---

<b>WHY UNEEK</b>	<b>3</b>
<b>IMPORTANT INFORMATION</b>	<b>4</b>
<b>COMPONENTS AND PARTS</b>	<b>5</b>
<b>STEP 1</b>	<b>6</b>
<b>STEP 2</b>	<b>6</b>
<b>STEP 3</b>	<b>6</b>
<b>STEP 4</b>	<b>6</b>
<b>STEP 5</b>	<b>7</b>
<b>STEP 6</b>	<b>7</b>
<b>STEP 7</b>	<b>7</b>
<b>STEP 8</b>	<b>8</b>
<b>STEP 9</b>	<b>8</b>
<b>STEP 10</b>	<b>8</b>
<b>FINISHED PRODUCT</b>	<b>9</b>

# ***Why Uneek***

---

## ***Australian Designed and Built***

All our products are designed and manufactured right here in Australia, allowing us to have better lead times and better quality control than companies manufacturing overseas. By supporting us you're supporting to grow the Australian economy and our brand.

## ***Uneek Styling***

We do not design our bars to look the same across the vehicle range. We fully develop our own product to individually suit each vehicle. We take time in designing from scratch and then test all our bars to comply with all relevant ADRs and Australian Standards.

## ***Lightweight Through Smart Engineering***

Having a steel bar doesn't mean you have to add more weight than is required to the front of your vehicle. Our engineering practises ensure we have the right protection, designed the right way to ensure protection is at its maximum and weights at its minimum.

## ***Proven Off Road***

We take our products out and test them right here in the heart of our country in our Australian conditions so we know our products can withstand anything you throw at them.

## ***Increased Approach Angles***

Our bars are designed to give you the best advantage while off road, with increased approach angles means you can tackle those tough and steep angles better than you could with the original setup or other alternatives.

## ***Warranty***

Uneek 4x4 back itself as Australia's leading steel bull bar manufacturer. This is why we provide you with the best steel bar warranty in Australia - 5 years.

# Important Information

---



## PLEASE READ BEFORE INSTALLATION.

- When installed in accordance with these instructions, the front protection bar does not affect the operation of the vehicles SRS airbags.
- This product must be installed exactly as per these instructions using only hardware supplied.
- Take a few moments to read instructions thoroughly before beginning work.
- In the event of damage to any bar component please contact Uneek 4x4 in regards to repair/replacement of components.
- Do not use this product for any vehicle make or model other than that specified on these instructions.
- Do not remove labels from this product.
- This product and its fixings must not be modified in any way unless stated in these fitting instructions.
- The installation of this product is recommended for trained personnel.
- These instructions are correct at time of publication. Uneek 4x4 cannot be held responsible for the impact of any changes subsequently made by the vehicle manufacturer.
- During installation it is the duty of the installer to check correct operation/clearances of all components.
- Supplied tow points are designed as tow points only. Use in a recovery operation will be at operator's risk.
- Installation time:1-2 hours.
- This bar is only legal on Australian roads when the wings are fitted. Uneek 4x4 bears no responsibility to and legal problems that arise when driving on public roads with wings removed.



### EYE & EAR PROTECTION REQUIRED



### DRILLING REQUIRED



### TWO PERSON LIFT REQUIRED



### TORQUE SETTING



### CUTTING OR GRINDING REQUIRED

---

#### FASTENER TORQUE SETTINGS:

M6 – 9Nm (4lb ft)

M8 – 22Nm (16lb ft)

M10 – 44Nm (32lb ft)

M12 – 77Nm (57lb ft)

TOOLS REQUIRED:

BASIC TOOL KIT WITH SOCKETS, SPANNERS AND 5MM HEX KEY

# Components and parts

ITEM NO.	PART NUMBER	DESCRIPTION	QTY.
1	JK-FB-M-ASM1	TOURING BAR WELDMENT	1
2	JK-FB-M-ASM2	LH WING JK MODULAR	1
3	JK-FB-M-ASM2R.	RH WING JK MODULAR	1
4	M12-1.75 x 30	M12x30-8.8 HEX BOLT Z/P	6
5	M12 HD WASHER	M12 HD WASHER	6
6	M12 SPRING WASHER	M12 SPRING WASHER	6
7	JK-FB-T-14	SPOT LIGHT MOUNT	2
8	M4 x 16 pan head screw	M4 x 16 Pan head screw z/p	8
9	M10-1.5 x 30	M10x30 HEX BOLT Z/P 8.8	8
10	M10 HD WASHER	M10 HD WASHER Z/P	8
11	M10 SPRING WASHER	M10 SPRING WASHER	8
12	M8 WASHER	M8 WASHER	4
13	M8X25 BHCS	M8X25 BUTTON HEAD CAP SCREW Z/P	4
14	SHIPPER 1200 X 600 X 300	CARTON 1200 X 600 X 300	1
15	U4X4-LOGO PLATE- 1	LOGO PLATE-1	1

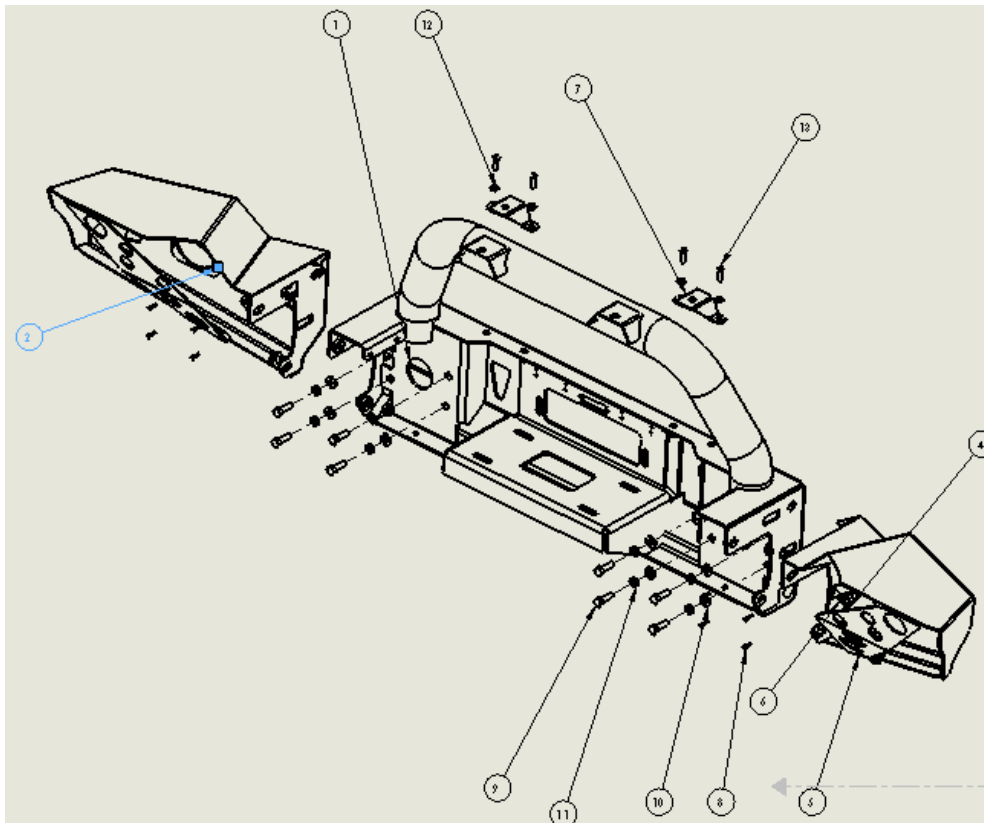

## Step 1

Remove factory bumper.

Remove infill-push in clips that are located 2 on the top infill panel in front of the grille, 2 underneath on cross member and 2 under fender flares.

Remove 8 M12 bolts connecting bumper to chassis.



## Step 2

The picture to the right shows what your car will look like with the factory bumper and hardware removed.



## Step 3

Line up your stock fog lights with the mounting holes and secure with M4 pan head screws.



## Step 4

If fitting optional winch light, lightly tap in the light into recess hole with a mallet and secure with self-tapping screws.



## Step 5

Lift center section up to the jeep and secure with 8 M10 x 30 bolts spring washers and washers. Ensure you refit the horn with 2 of the bolts.



## Step 6

Torque all M10 bolts.



## Step 7

To fit wings to bar carefully position wing retaining hooks inside corresponding slot on center section, then slide the wing back towards the car. Now fit 3 M12 bolts, spring washers and flat washers per wing and torque up.

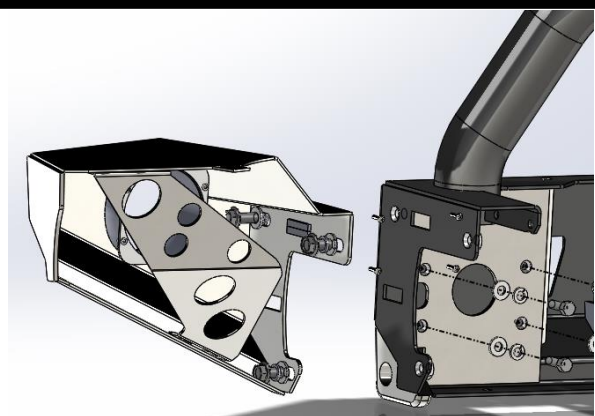

## Step 8

When fitting some winches with extended motor housings it will become evident the winch motor contacts a folded lip on the chassis. If this is the case you will need to use an angle grinder to trim the folded edge away to allow the motor to fit.

**Most winches do not require this modification.**



## Step 9

Install the driving light mounts either forward or backward depending on your lights. Ideally you should push the light back as far as it can go but may need to turn around to clear the winch clutch. Fit each bracket with M8 button head cap screws, spring washers and flat washers. Torque down.



## Step 10

If using the Uneek 4x4 number plate flip, use supplied M6 hardware to fit to the bull bar now.





# ***Finished Product***

---



Revised: 26/07/2019

***Australia's Best  
Off Road Products  
Created... Not Cloned***

20 Gateway Drive, Carrum Downs, VIC, 3201

1800 806 952

[www.uneek4x4.com.au](http://www.uneek4x4.com.au)

