

UNEK4
AUSTRALIA
OFF ROAD ACCESSORIES

SKU: WH-FB-05U-ASM0



Fitting Instructions

Jeep Grand Cherokee WH 2005-2010

Front Protection Bar

**Australia's Best Off Road Products
Created... Not Cloned**

Contents

WHY UNEEK	3
IMPORTANT INFORMATION	4
COMPONENTS AND PARTS	5
STEP 1	6
STEP 2	6
STEP 3	6
STEP 4	6
STEP 5	7
STEP 6	7
STEP 7	7
STEP 8	7
STEP 9	8
STEP 10	8
STEP 11	8
STEP 12	8
STEP 13	9
STEP 14	9
STEP 15	9
STEP 16	9
STEP 17	10
STEP 18	10
STEP 19	10
STEP 20	10
STEP 21	11
STEP 22	11
STEP 23	11
STEP 24	11
STEP 25	12
STEP 26	12
STEP 27	12
STEP 28	12
STEP 29	13
STEP 30	13
STEP 31	13
STEP 32	13
STEP 33	14
STEP 34	14
STEP 35	14
STEP 36	14
STEP 37	15
FINISHED PRODUCT	16

Why Uneek

Australian Designed and Built

All our products are designed and manufactured right here in Australia, allowing us to have better lead times and better quality control than companies manufacturing overseas. By supporting us you're supporting to grow the Australian economy and our brand.

Uneek Styling

We do not design our bars to look the same across the vehicle range. We fully develop our own product to individually suit each vehicle. We take time in designing from scratch and then test all our bars to comply with all relevant ADRs and Australian Standards.

Lightweight Through Smart Engineering

Having a steel bar doesn't mean you have to add more weight than is required to the front of your vehicle. Our engineering practises ensure we have the right protection, designed the right way to ensure protection is at its maximum and weights at its minimum.

Proven Off Road

We take our products out and test them right here in the heart of our country in our Australian conditions so we know our products can withstand anything you throw at them.

Increased Approach Angles

Our bars are designed to give you the best advantage while off road, with increased approach angles means you can tackle those tough and steep angles better than you could with the original setup or other alternatives.

Warranty

Uneek 4x4 back itself as Australia's leading steel bull bar manufacturer. This is why we provide you with the best steel bar warranty in Australia - 5 years.

Important Information



PLEASE READ BEFORE INSTALLATION.

- When installed in accordance with these instructions, the front protection bar does not affect the operation of the vehicles SRS airbags.
- This product must be installed exactly as per these instructions using only hardware supplied.
- Take a few moments to read instructions thoroughly before beginning work.
- In the event of damage to any bar component please contact Uneek 4x4 in regards to repair/replacement of components.
- Do not use this product for any vehicle make or model other than that specified on these instructions.
- Do not remove labels from this product.
- This product and its fixings must not be modified in any way unless stated in these fitting instructions.
- The installation of this product is recommended for trained personnel.
- These instructions are correct at time of publication. Uneek 4x4 cannot be held responsible for the impact of any changes subsequently made by the vehicle manufacturer.
- During installation it is the duty of the installer to check correct operation/clearances of all components.
- Supplied tow points are designed as tow points only. Use in a recovery operation will be at operator's risk.
- Installation time: 3-4 hours
- Vehicle specific notes: A flip up license plate kit may also be required.



EYE & EAR PROTECTION REQUIRED



DRILLING REQUIRED



TWO PERSON LIFT REQUIRED



TORQUE SETTING



CUTTING OR GRINDING REQUIRED

FASTENER TORQUE SETTINGS:

M6 – 9Nm (4lb ft)

M8 – 22Nm (16lb ft)

M10 – 44Nm (32lb ft)

M12 – 77Nm (57lb ft)

TOOLS REQUIRED: Basic tool kit with spanners, allen keys and socket set. Soldering iron or electrical in-line connectors.

Male and female spade terminals.

Power Drill, 11mm and 13mm drill bits, centre punch and hammer. Black adhesive silicone.

Components and parts

ITEM NO.	PART NUMBER	DESCRIPTION	QTY.
1	03-0298R	BRACKET ASSY IMPACT WH	1
2	03-0298L	BRACKET ASSY IMPACT WH	1
3	M12X30X1.75	M12 X 30MM X 1.75 BOLT	6
4	M12 SW	M12 SPRING WASHER	10
5	M12 FW X 37	M12 FLAT WASHER X 37	10
6	M12X40X1.75	M12 X 40MM X 1.75 BOLT	8
7	M12 X 1.75 FN	M12 FLANGE NUT	8
8	M10X40X1.5	BOLT M10 X 40	4
9	M10FWX25	M10 FLAT WASHER X 25MM WIDE	4
10	M10SW	M10 SPRING WASHER	4
11	04-0086	ASSY M10 ROOT NUT PLATE	4

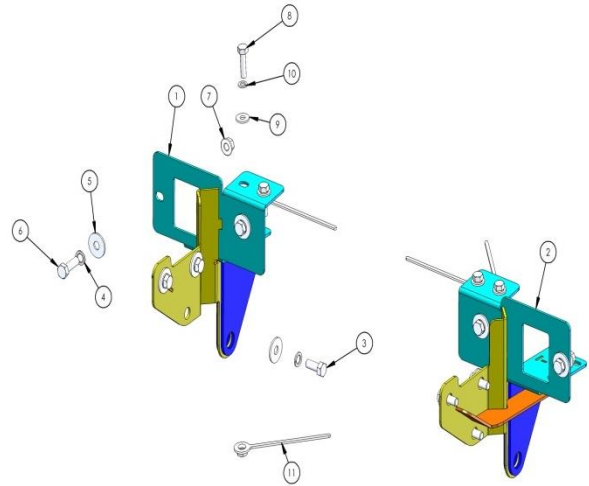

ITEM NO.	PART NUMBER	DESCRIPTION	QTY.
1	WH-FB-05-ASM1	WH JEEP WELDED ASSY	1
2	05-0064	TUBE ASSY FJ URBAN	1
3	M12X30X1.75	M12 X 30MM X 1.75 BOLT	2
4	M12 SW	M12 SPRING WASHER	2
5	M12 FW X 37	M12 FLAT WASHER X 37	2
6	CARWAY LED	FOG DRL LIGHT	2
7	M5X15 PSCREW	M5 X 15 PH SCREW	8
8	12-0011	COVER FOG GV	2
9	M5X10 PSCREW	M5 X 10 PH SCREW	6
10	09-0094	PANEL ASSY CENTER WH	1
11	09-0096R	PANEL OUTER WH	1
12	09-0096L	PANEL OUTER WH	1
13	M8X25 BHCS	M8 BUTTON HEAD CAP SCREW	19
14	M8 FW X 22	FLAT WASHER 8MM LARGE	13
15	M8 FN	FLANGE NUT M8	8
16	M6X20	M6 X 20 BOLT	7
17	M6 FW	M6 FLAT WASHER	7
18	M6 FN	FLANGE NUT M6	7
19	03-0300R	BRACKET LIGHT MOUNT WH	1
20	03-0300L	BRACKET LIGHT MOUNT WH	1
21	04-0232	PLATE WH INFILL	2
23	SPFM20	Round plastic cap Kelvindale	6

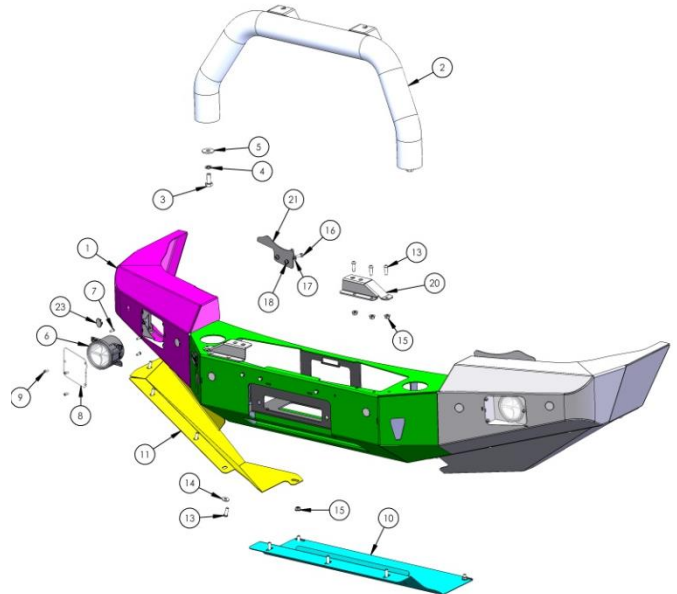

Step 1

You will begin by removing the factory bumper and ensuring you have all components for the bull bar before you begin installation.



Step 2

To remove factory bumper you will need to undo fasteners on the inside of the wheel well as shown. Do this for both sides.



Step 3

There are also small screws underneath quarter panel attaching top edge of bumper, undo both sides.



Step 4

Using a prying tool undo all the top clips holding the top of the grille on.

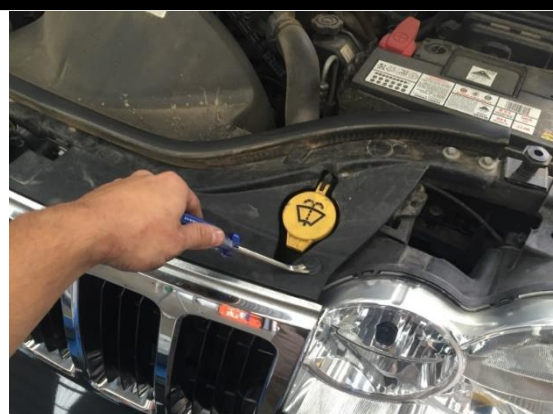

Step 5

Remove the grille.
There are also 3 screws under the bumper holding its back edge on to the lower cross member. Remove these screws and retain for later use.



Step 6

Remove screw holding center of bumper into place.



Step 7

Unplug the temperature sensor.



Step 8

If parking sensors are fitted, unplug the main loom now on the left-hand side of the car.



Step 9

Unplug the fog lights.



Step 10

Remove the bumper from the car. This can be saved, sold or discarded.



Step 11

If Parking sensors are fitted, you will now need to pry off the plastic housings of each. Leave sensor plugged in.

If no parking sensors are fitting on the vehicle use small black caps to plug holes on the bull bar.



Step 12

Here is a sensor that has been removed. Scrape off any residue on the sensor mounting surface.



Step 13

Remove plastic reinforcement from in front of steel cross member.



Step 14

Remove chassis caps on both sides.



Step 15

Remove factory tie down point.



Step 16

Feed sensors through bull bar so all can line up with corresponding sensor holes in the bar.



Step 17

Apply a small bead of adhesive silicon to the front plastic mounting face of the sensor housing.



Step 18

Firmly press the sensor in the bull bar and leave for at least 1.5 hours for them to dry in place.



Step 19

Fit Impact absorbers as shown. Feed M12 bolts up from underneath and secure with flange nuts to hold in place, then fit side bolt as shown. **Ensure the bracket is pushed as far as possible to the outside of the vehicle and still have the lower bolts in.** Left hand side of car shown.



Step 20

With a center punch mark all holes that need to be drilled.



Step 21

Using a Power drill, drill 11mm holes in the top surface and 13mm in the front.

Don't forget to wear safety glasses.



Step 22

Bend the stem of the nut plates and feed through bottom of steel cross member.



Step 23

Once nut plates are fed through, secure with M10 bolts and washers.



Step 24

Fit other side impact absorber and torque up all bolts.



Step 25

Fit supplied fog lights to bar, wire electrical terminals as required to factory loom.



Step 26

With the help of a friend lift the bar on to the vehicle and using M12 bolts with large washers secure to impact absorbers.

Bolt on the top hoop if not welded on.



Step 27

Position the bar along the car and when you're happy with where it should sit, torque up each M12 bolt from bar to impact absorbers.



Step 28

Face lift Grand Cherokees will need plate infill fitted under the head lights. Adjust this to have roughly a 5-10mm gap and then secure with M6 hardware. Pre face lift Jeeps will not need this part.

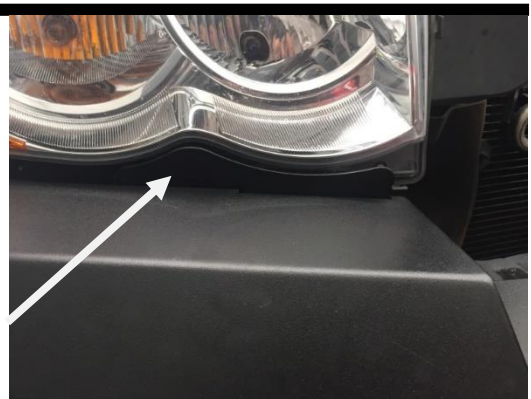

Step 29

If fitting a winch, make sure you fit it now before lower stone panels are fitted. Place winch on cradle from top and feed winch supplied bolts and secure from underneath. Torque down bolts.



Step 30

Using M6 hardware refit temperature sensor to centre bracket on steel crossmember as shown.



Step 31

Fit fog light polycarbonate covers over lights with M5 pan head screws.



Step 32

Fit winch fairlead and control box. Uneek 4x4 can supply a bracket that mounts over some winches cable area or motor area. Call us to source. This bracket is compatible with most Runva winches.



Step 33

Loosely fit all stone panels on to the bar with M8 button head cap screws and washers.



Step 34

Using screws from vehicle fit the centre stone panel and outside stone panels to the bottom crossmember of the Jeep. Then torque up all stone panels.



Step 35

Fit spotlight mounts if required.



Step 36

Fit optional number plate flip if required.



Step 37

Tuck in wheel well liner behind stone panel and bar wings.



Finished Product



Revised: 29/07/2019

***Australia's Best
Off Road Products
Created... Not Cloned***

49-75 Pacific Drive, Keysborough, VIC, 3173

1300 806 952

www.uneek4x4.com.au

