

UNEK4
AUSTRALIA
OFF ROAD ACCESSORIES

SKU: GQ-FB-C-ASM0



Fitting Instructions

All GQ Models Y60 1989-1997

Front Protection Bar

***Australia's Best Off Road Products
Created... Not Cloned***

Contents

WHY UNEEK	3
IMPORTANT INFORMATION	4
COMPONENTS AND PARTS	5
STEP 1	6
STEP 2	6
STEP 3	6
STEP 4	6
STEP 5	7
STEP 6	7
STEP 7	7
STEP 8	8
STEP 9	8
FINISHED PRODUCT	9

Why Uneek

Australian Designed and Built

All our products are designed and manufactured right here in Australia, allowing us to have better lead times and better quality control than companies manufacturing overseas. By supporting us you're supporting to grow the Australian economy and our brand.

Uneek Styling

We do not design our bars to look the same across the vehicle range. We fully develop our own product to individually suit each vehicle. We take time in designing from scratch and then test all our bars to comply with all relevant ADRs and Australian Standards.

Lightweight Through Smart Engineering

Having a steel bar doesn't mean you have to add more weight than is required to the front of your vehicle. Our engineering practises ensure we have the right protection, designed the right way to ensure protection is at its maximum and weights at its minimum.

Proven Off Road

We take our products out and test them right here in the heart of our country in our Australian conditions so we know our products can withstand anything you throw at them.

Increased Approach Angles

Our bars are designed to give you the best advantage while off road, with increased approach angles means you can tackle those tough and steep angles better than you could with the original setup or other alternatives.

Warranty

Uneek 4x4 back itself as Australia's leading steel bull bar manufacturer. This is why we provide you with the best steel bar warranty in Australia - 5 years.

Important Information



PLEASE READ BEFORE INSTALLATION.

- This product must be installed exactly as per these instructions using only hardware supplied.
- Take a few moments to read instructions thoroughly before beginning work.
- In the event of damage to any bar component please contact Uneek 4x4 in regards to repair/replacement of components.
- Do not use this product for any vehicle make or model other than that specified on these instructions.
- This product and its fixings must not be modified in any way unless stated in these fitting instructions.
- The installation of this product is recommended for trained personnel.
- These instructions are correct at time of publication. Uneek 4x4 cannot be held responsible for the impact of any changes subsequently made by the vehicle manufacturer.
- During installation it is the duty of the installer to check correct operation/clearances of all components.
- Supplied tow points are designed as tow points only. Use in a recovery operation will be at operator's risk.
- Installation time: 1-2 hours.



EYE & EAR PROTECTION REQUIRED



DRILLING REQUIRED



TWO PERSON LIFT REQUIRED



TORQUE SETTING



CUTTING OR GRINDING REQUIRED

FASTENER TORQUE SETTINGS:

M6 – 9Nm (4lb ft)

M8 – 22Nm (16lb ft)

M10 – 44Nm (32lb ft)

M12 – 77Nm (57lb ft)

TOOLS REQUIRED:

BASIC TOOL KIT, POWDER DRILL, 12MM DRILL BIT, CENTRE PUNCH.

Components and parts

ITEM NO.	PART NUMBER	DESCRIPTION	QTY.
1	AUTO 8 LED	LED INDICATOR/PARKER	2
2	GQ-FB-ASM2L	Chassis mount LH ASM	1
3	GQ-FB-ASM2R	Chassis mount RH ASM	1
4	GQ-FB-ASM3L	NUT PLATE LH	1
5	M12 FLAT STANDARD	M12 FLAT WASHER	16
6	M12 SPRING WASHER	M12 SPRING WASHER	13
7	M12X40X1.75	M12 X 40 X 1.75 BOLT	13
8	GQ-FB-T-ASM1	GQ BULL BAR WELDMENT	1
9	U4X4-LOGO PLATE- 1	LOGO PLATE-1	1
10	M12 NUT	M12 X 1.75 NUT	3
11	M6X20	BOLT M6 X 20	2
12	M6 FW	FLAT WASHER 6MM	2
13	M6 FLANGE NUT	M6 FLANGE NUT	2
14	SHIPPER 1950 X 720 X 380	CARTON 1950 X 720 X 380	1

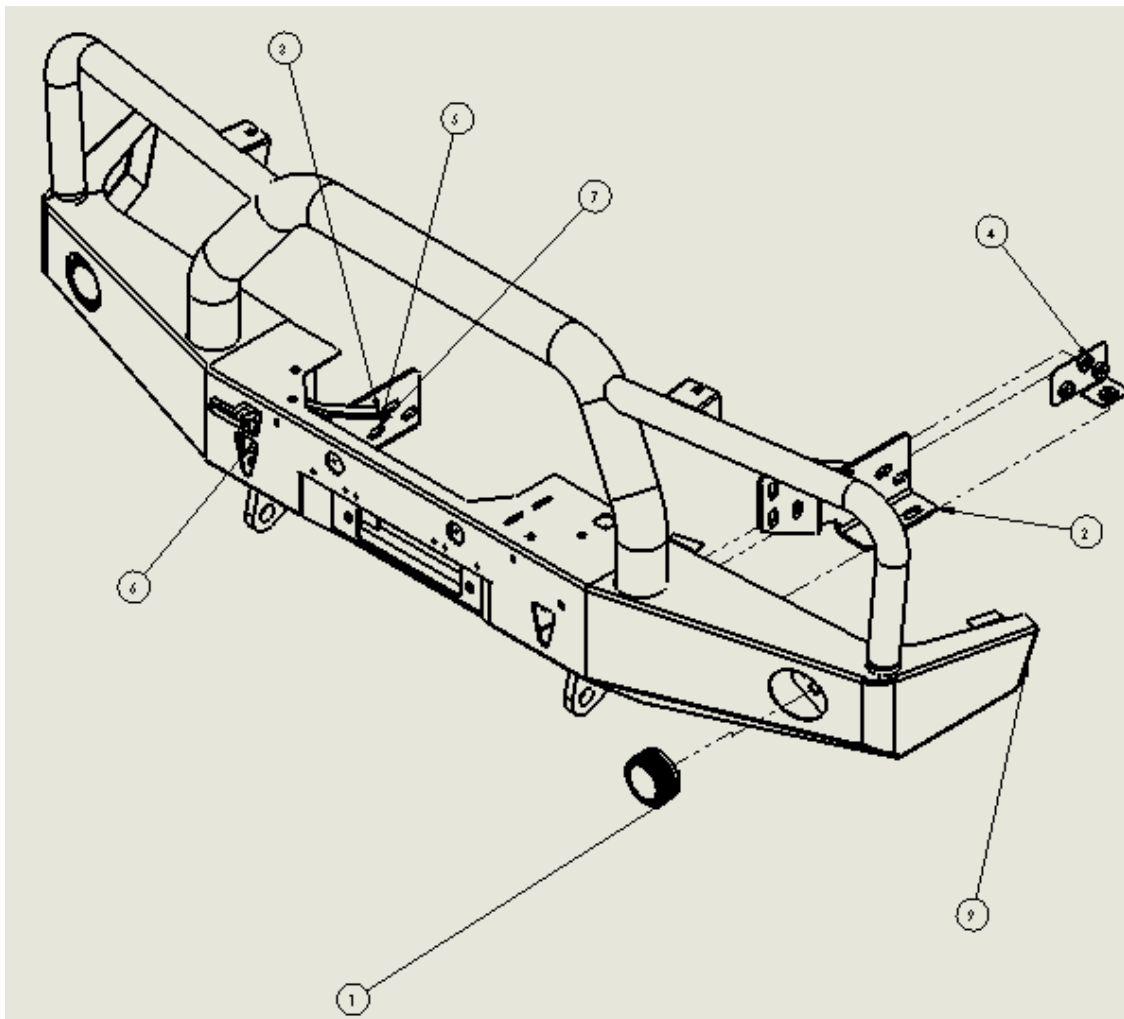

Step 1

Remove bumper. Keep original fasteners together.



Step 2

Fit LHS chassis bracket with nut plate inside chassis rails. Push the bracket back as far as it can go towards the car and torque up M12 x 40 bolts with spring washers and flat washers.



Step 3

Fit LED winch light to winch cradle if purchased. Run wire between winch cradle and bar. Secure to cradle using cable tie.

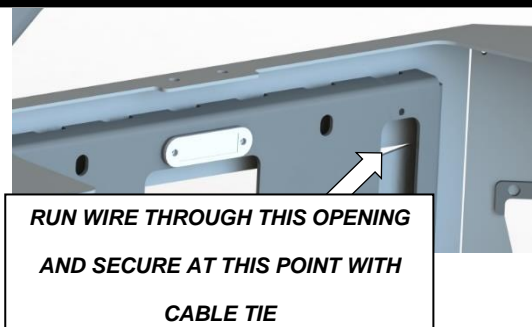

Step 4

Fit RHS chassis bracket with factory bolts on the side and new M12 bolt on nut on the underside. Remember to push the bracket back as far as it will go.



Step 5

With the help of another person lift bull bar onto vehicle and secure using M12 x 40 bolts, spring washers and large flat washers.

The top 3 mounting holes are for vehicles with no body lift.

If your Patrol has a 2" body lift, lift the bar higher and use the bottom 3 mounting hole

Standard height mounting holes shown to the right.

Adjust the bar to the height you are happy with then you will need to drill 1 pinning hole per side to lock the bar in place. That bolt is shown to the right with an arrow. Once the hole is drilled secure with M12 bolt, spring washer, washer and nut. Torque all bolts.

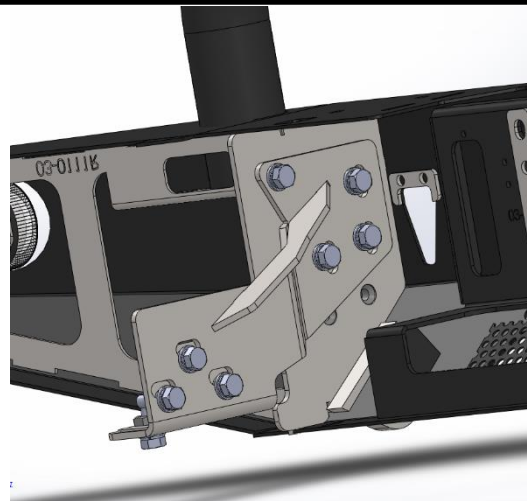

Step 6

Fit indicators with supply flange nuts and torque up.



Step 7

Wire in the indicators.

GREEN is indicator, BROWN is parker and WHITE is earth.



Step 8

Secure winch to cradle using bolts and fairlead supplied with winch. NOTE: If using a low mount winch ensure the clutch handle is accessed easily. Refer to winch manual in regards to gearbox rotation.

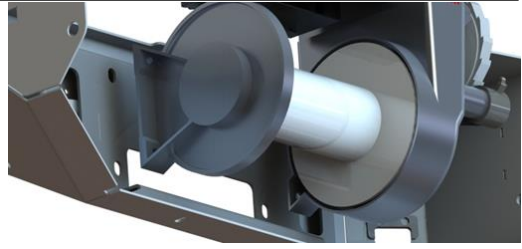

Step 9

Fit your number plate to the front with supplied M6 bolts washers and flange nuts.



Finished Product



Revised: 01/08/2019

***Australia's Best
Off Road Products
Created... Not Cloned***

20 Gateway Drive, Carrum Downs, VIC, 3201

1800 806 952

www.uneek4x4.com.au

