

**UNEK44**  
AUSTRALIA  
OFF ROAD ACCESSORIES

**SKU: TL-S-LC200-ASM0**



## ***Fitting Instructions***

**TOYOTA LANDCRUISER 200 SERIES**

***Sliders***

**Australia's Best Off Road Products  
Created... Not Cloned**

# Contents

---

<b>Why Uneek</b>	3
<b>Important Information</b>	4
<b>Components and part</b>	5
<b>Step 1: Prepare Vehicle</b>	6
<b>Step 2: Insert Nut Plates into Front Chassis Rails</b>	6
<b>Step 3: Prepare Sliders</b>	6
<b>Step 4: Align Right Hand Side Rear Mount</b>	7
<b>Step 5: Align Right Hand Side Front Mount</b>	8
<b>Step 6: Secure all bolts</b>	9
<b>Step 7: Repeat Steps for Left Hand Side</b>	10
<b>Step 8: Finish</b>	10
<b>Finished Product</b>	10

# ***Why Uneek***

---

## ***Australian Designed and Built***

All our products are designed and manufactured right here in Australia, allowing us to have better lead times and better quality control than companies manufacturing overseas. By supporting us you're supporting to grow the Australian economy and our brand.

## ***Uneek Styling***

We do not design our bars to look the same across the vehicle range. We fully develop our own product to individually suit each vehicle. We take time in designing from scratch and then test all our bars to comply with all relevant ADRs and Australian Standards.

## ***Lightweight Through Smart Engineering***

Having a steel bar doesn't mean you have to add more weight than is required to the front of your vehicle. Our engineering practises ensure we have the right protection, designed the right way to ensure protection is at its maximum and weights at its minimum.

## ***Proven Off Road***

We take our products out and test them right here in the heart of our country in our Australian conditions so we know our products can withstand anything you throw at them.

## ***Increased Approach Angles***

Our bars are designed to give you the best advantage while off road, with increased approach angles means you can tackle those tough and steep angles better than you could with the original setup or other alternatives.

## ***Warranty***





Uneek4x4 back itself as Australia's leading steel bull bar manufacturer. This is why we provide you with the best steel bar warranty in Australia - 5 years.

# Important Information



**PLEASE READ BEFORE INSTALLATION.**

- When installed in accordance with these instructions, rock sliders do not affect the operation of the vehicles SRS airbags.
- This product must be installed exactly as per these instructions using only hardware supplied.
- Take a few moments to read instructions thoroughly before beginning work.
- In the event of damage to any bar component please contact Uneek 4x4 in regards to repair/replacement of components.
- Do not use this product for any vehicle make or model other than that specified on these instructions.
- Do not remove labels from this product.
- This product and its fixings must not be modified in any way unless stated in these fitting instructions.
- The installation of this product is recommended for trained personnel.
- These instructions are correct at time of publication. Uneek 4x4 cannot be held responsible for the impact of any changes subsequently made by the vehicle manufacturer.
- During installation it is the duty of the installer to check correct operation/clearances of all components.
- Installation time: 1.5 hour.
- Vehicle specific notes: A hydraulic jack will be required. Please note that the threads in the captive nut end plates are 1.5 pitch.

	<b>EYE &amp; EAR PROTECTION REQUIRED</b>
	<b>DRILLING REQUIRED</b>
	<b>TWO PERSON LIFT REQUIRED</b>
	<b>TORQUE SETTING</b>
	<b>CUTTING OR GRINDING REQUIRED</b>

**FASTENER TORQUE SETTINGS:**

- M6 – 9Nm (4lb ft)
- M8 – 22Nm (16lb ft)
- M10 – 44Nm (32lb ft)
- M12 – 77Nm (57lb ft)

**TOOLS REQUIRED:**

Basic tool kit: Hydraulic jack, 'G' or 'F' clamp, drill and 10mm drill bit, sharp Stanley knife.

# Components and part

## MAIN PARTS

ITEM NO.	PART NUMBER	DESCRIPTION	Default/QTY
1	TL-S-LC200-ASM2R	LC200 Rock Slider Lower Mount Assy	1
2	TL-S-LC200-ASM2L	LC200 Rock Slider Lower Mount Assy	1
3	TL-S-LC200-ASM1R	Toyota LC200 Rock Slider Weldment	1
4	TL-S-LC200-ASM1L	Toyota LC200 Rock Slider Weldment	1
5	03-0728	Rear Strap LC200 Slider	2
6	09-0190	Rock Slider Step Panel LC200	2

## SMALL PARTS KIT

ITEM NO.	PART NUMBER	DESCRIPTION	Default/QTY
7	M6 x 16 BHCS	M6 X 16 BHCS	16
8	M6 FLANGE NUT	M6 FLANGE NUT	16
9	M12X30	M12 X 30 HEX HT	14
10	M12X110X1.75	M12 X 110MM X 1.75 BOLT	2
11	M12 FW	M12 FLAT WASHER	12
12	M12 FW X 37	M12 FLAT WASHER LARGE	4
13	JK-S-10	LOGO PLATE	2
14	04-0276	M12 SMALL NUT PLATE ASSY	2
15	04-0252	NUT PLATE ASSY M12 RECOVERY	2

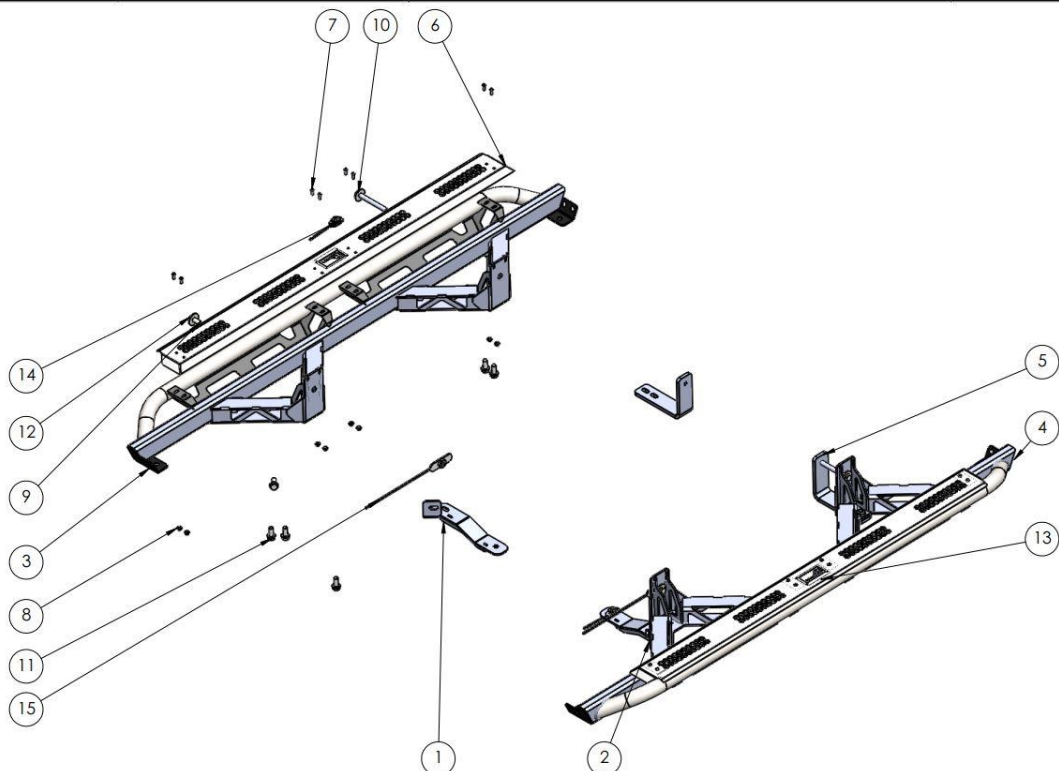

---

## **Step 1: Prepare Vehicle**

- Remove original side steps and brackets.

---

## **Step 2: Insert Nut Plates into Front Chassis Rails**

- Bend nut plate stem and insert through the bottom hole of the forward cross member. Ensure the protrudes through the upper opening in the chassis rail and the nut is aligned to accept a bolt through the bottom hole.
- Leave nut plates in chassis for later stage



ITEM NO.	PART NUMBER	DESCRIPTION	PREPARE nut PLATE/QTY.
1	04-0276	M12 SMALL NUT PLATE ASSY	2

---

## **Step 3: Prepare Sliders**

Fit the tread plate sections to the sliders using M6 button head cap screws and M6 flange nuts.

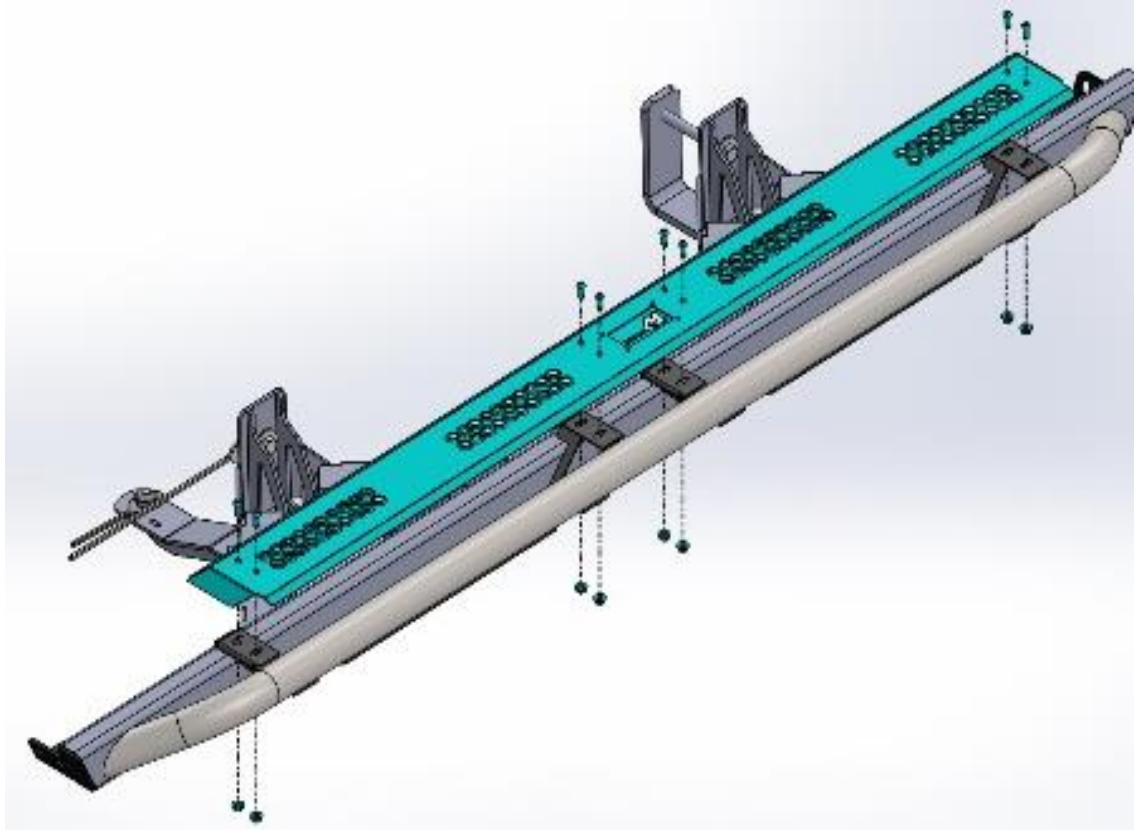

PART NUMBER	DESCRIPTION	step/QTY.
M6 x 16 BHCS	M6 X 16 BHCS	16
M6 FLANGE NUT	M6 FLANGE NUT	16



M6-9Nm

---

## **Step 4: Align Right Hand Side Rear Mount**

- Position the slider against the chassis rail and loosely fit the rear bracket.

Note: It is advisable to remove the fuel tank cover on the right-hand side of the vehicle for easier sight to mounting brackets.

Note: Assistance from another person and or hydraulic jack will be required to lift sliders into position.

Caution: Ensure adequate clearance between all mountings and hardware and vehicle fuel and brake lines

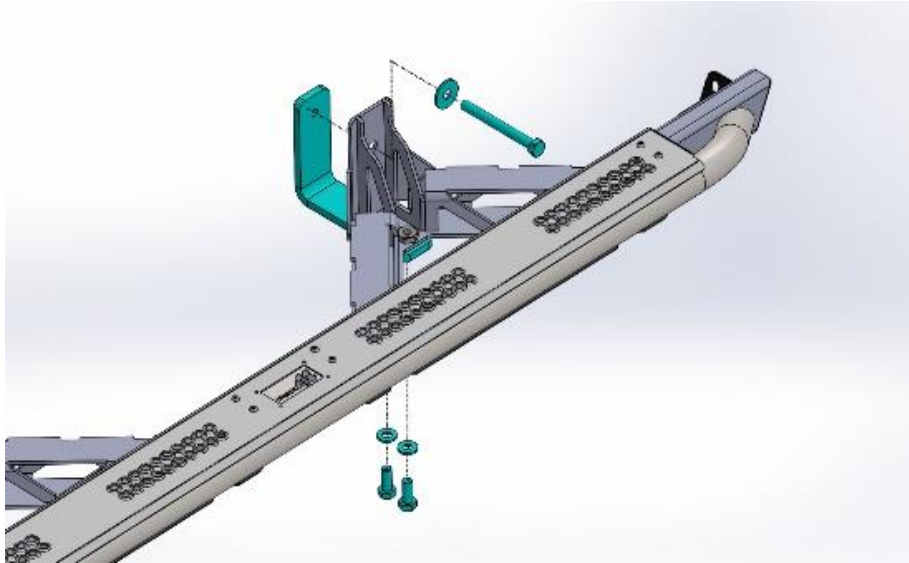

PART NUMBER	DESCRIPTION	rear mount/QTY.
M12 FW X 37	M12 FLAT WASHER LARGE	2
M12 FW	M12 FLAT WASHER	4
M12X110X1.75	M12 X 110MM X 1.75 BOLT	2
M12X30	M12 X 30 HEX HT	4



M12-77Nm

## **Step 5: Align Right Hand Side Front Mount**

- Align mount holes in front bracket to the corresponding holes in the chassis.
- Fit internal nut plates into chassis, bending plate arms as needed and secure. (nut plate facing towards the ground should already be in place from step 2)
- Align sliders to vehicle sills and loosely secure fasteners.



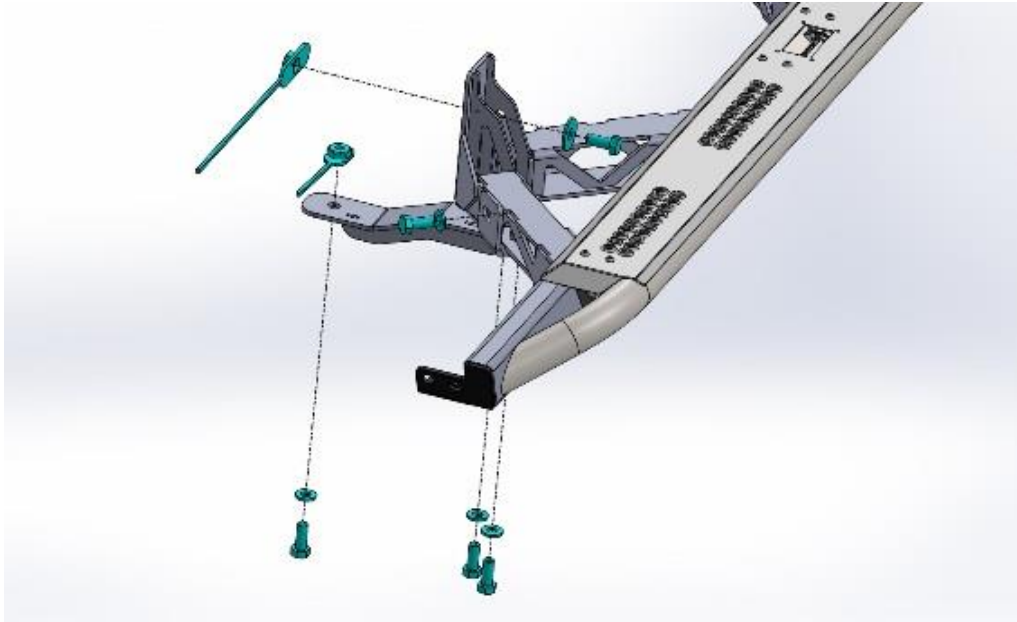

PART NUMBER	DESCRIPTION	front mount/QTY.
M12X30	M12 X 30 HEX HT	10
M12 FW	M12 FLAT WASHER	8
M12 FW X 37	M12 FLAT WASHER LARGE	2
04-0276	M12 SMALL NUT PLATE ASSY	2
04-0252	NUT PLATE ASSY M12 RECOVERY	2

Note: 04-0276 was placed in chassis rail in step 2.

Tip: A large F clamp or G clamp is useful to hold inner mounts hard up against chassis rails whilst aligning the slider.



M12-77Nm

## **Step 6: Secure all bolts**

Adjust sliders into position and secure all mounting bolts to the vehicle

---

## ***Step 7: Repeat Steps for Left Hand Side***

Repeat steps 4-6 for left hand side of vehicle

---

## ***Step 8: Finish***

Step back and admire your work. Awesome job!

---

## ***Finished Product***

---



Revised: 29/11/2019

***Australia's Best  
Off Road Products  
Created... Not Cloned***

20 Gateway Drive, Carrum Downs, VIC, 3201

1800 806 952

[www.uneek4x4.com.au](http://www.uneek4x4.com.au)

