

**UNEK4**  
AUSTRALIA  
OFF ROAD ACCESSORIES

**SKU: TL-CM-200-ASM0**



## ***Fitting Instructions***

***Toyota Land Cruiser 200 Series***

***Compressor Mount 200 Series LC***

***Australia's Best Off Road Products  
Created... Not Cloned***

# **Contents**

---

<b>WHY UNEEK</b>	<b>3</b>
<b>IMPORTANT INFORMATION</b>	<b>4</b>
<b>COMPONENTS AND PARTS</b>	<b>5</b>
<b>STEP 1</b>	<b>6</b>
<b>STEP 2</b>	<b>6</b>
<b>STEP 3</b>	<b>6</b>
<b>FINISHED PRODUCT</b>	<b>7</b>

# ***Why Uneek***

---

## ***Australian Designed and Built***

All our products are designed and manufactured right here in Australia, allowing us to have better lead times and better quality control than companies manufacturing overseas. By supporting us you're supporting to grow the Australian economy and our brand.

## ***Uneek Styling***

We do not design our bars to look the same across the vehicle range. We fully develop our own product to individually suit each vehicle. We take time in designing from scratch and then test all our bars to comply with all relevant ADRs and Australian Standards.

## ***Lightweight Through Smart Engineering***

Having a steel bar doesn't mean you have to add more weight than is required to the front of your vehicle. Our engineering practises ensure we have the right protection, designed the right way to ensure protection is at its maximum and weights at its minimum.

## ***Proven Off Road***

We take our products out and test them right here in the heart of our country in our Australian conditions so we know our products can withstand anything you throw at them.

## ***Increased Approach Angles***

Our bars are designed to give you the best advantage while off road, with increased approach angles means you can tackle those tough and steep angles better than you could with the original setup or other alternatives.

## ***Warranty***

Uneek 4x4 back itself as Australia's leading steel bull bar manufacturer. This is why we provide you with the best steel bar warranty in Australia - 5 years.

# Important Information

---



**PLEASE READ BEFORE INSTALLATION.**

- Take a few moments to read instructions thoroughly before beginning work.
- In the event of damage to any component please contact Uneek 4x4 in regards to repair/replacement of components.
- Do not use this product for any vehicle make or model other than that specified on these instructions.
- This product and its fixings must not be modified in any way unless stated in these fitting instructions.
- These instructions are correct at time of publication. Uneek 4x4 cannot be held responsible for the impact of any changes subsequently made by the vehicle manufacturer.
- During installation it is the duty of the installer to check correct operation/clearances of all components.
- Installation time: 15 min for bracket only
- These instructions only cover installing the bracket not the compressor.
- This bracket has been specifically designed to suit and ARB 12V compressor however other brands may fit.



**EYE & EAR PROTECTION REQUIRED**



**DRILLING REQUIRED**



**TWO PERSON LIFT REQUIRED**



**TORQUE SETTING**



**CUTTING OR GRINDING REQUIRED**

---

**FASTENER TORQUE SETTINGS:**

M6 – 9Nm (4lb ft)

M8 – 22Nm (16lb ft)

M10 – 44Nm (32lb ft)

M12 – 77Nm (57lb ft)

**TOOLS REQUIRED:**

Basic tool kit with spanners and socket set.

# **Components and parts**

ITEM NO.	PART NUMBER	DESCRIPTION	QTY.
1	03-0621	200 series compressor mount	1
2	U4X4-LOGO PLATE- 2	logo plate small	1

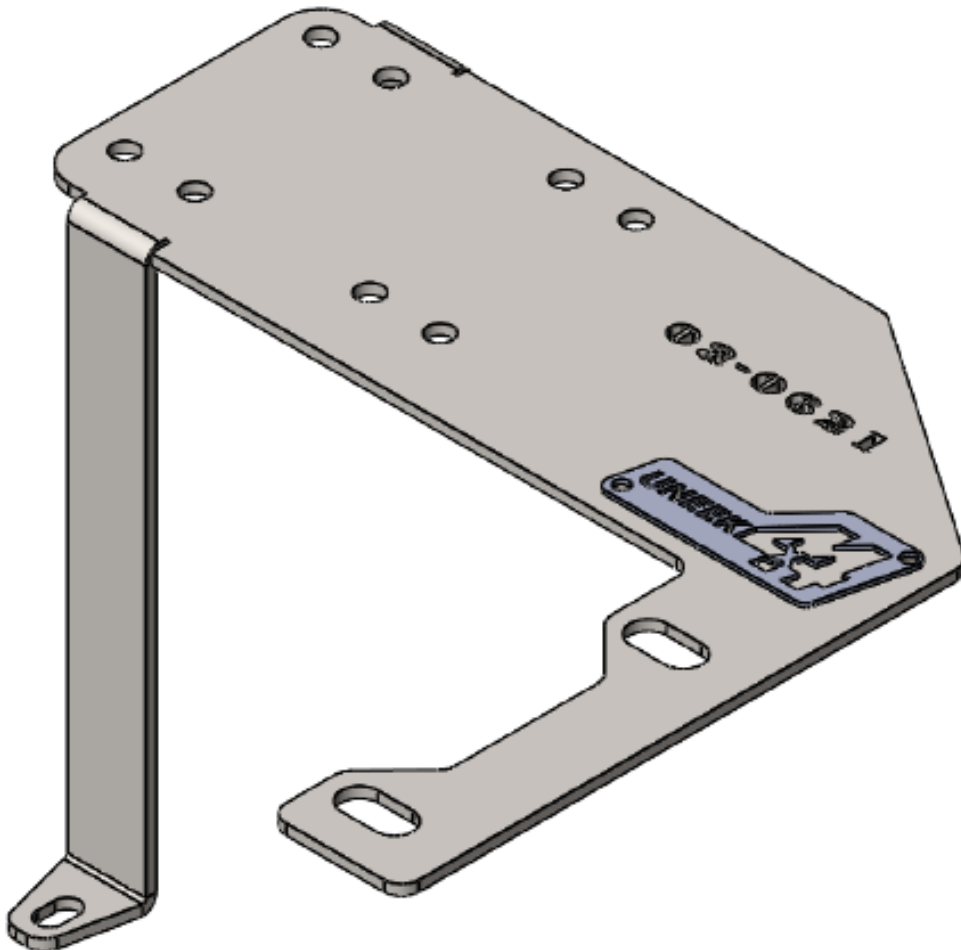

## Step 1

Mount the bracket as shown in the picture using hardware that is already on the vehicle. This area is near the firewall on the LHS of the vehicle. One nut is down below and can't be seen in this photo. Torque down all nuts.



## Step 2

If fitting an ARB compressor use the holes closer to the centre of the vehicle to fit the compressor mount.



## Step 3

Mount Compressor and wire up as required.



# ***Finished Product***

---





Revised: 21/08/2019

***Australia's Best  
Off Road Products  
Created... Not Cloned***

20 Gateway Drive, Carrum Downs, VIC, 3201

1800 806 952

[www.uneek4x4.com.au](http://www.uneek4x4.com.au)

