

**UNEK4**  
AUSTRALIA  
OFF ROAD ACCESSORIES

**SKU: TL-SR-78-ASM0**



# ***Fitting Instructions***

## ***Toyota 76,78,79 Series***

### ***Side Rails***

***Australia's Best Off Road Products  
Created... Not Cloned***

# **Contents**

---

<b>WHY UNEEK</b>	<b>3</b>
<b>IMPORTANT INFORMATION</b>	<b>4</b>
<b>COMPONENTS AND PARTS</b>	<b>5</b>
<b>STEP 1</b>	<b>6</b>
<b>STEP 2</b>	<b>8</b>
<b>STEP 3</b>	<b>9</b>
<b>STEP 4</b>	<b>9</b>
<b>STEP 5</b>	<b>10</b>
<b>FINISHED PRODUCT</b>	<b>11</b>

## ***Why Uneek***

---

### ***Australian Designed and Built***

All our products are designed and manufactured right here in Australia, allowing us to have better lead times and better quality control than companies manufacturing overseas. By supporting us you're supporting to grow the Australian economy and our brand.

### ***Uneek Styling***

We do not design our bars to look the same across the vehicle range. We fully develop our own product to individually suit each vehicle. We take time in designing from scratch and then test all our bars to comply with all relevant ADRs and Australian Standards.

### ***Lightweight Through Smart Engineering***

Having a steel bar doesn't mean you have to add more weight than is required to the front of your vehicle. Our engineering practises ensure we have the right protection, designed the right way to ensure protection is at its maximum and weights at its minimum.

### ***Proven Off Road***

We take our products out and test them right here in the heart of our country in our Australian conditions so we know our products can withstand anything you throw at them.

### ***Increased Approach Angles***

Our bars are designed to give you the best advantage while off road, with increased approach angles means you can tackle those tough and steep angles better than you could with the original setup or other alternatives.

### ***Warranty***

Uneek 4x4 back itself as Australia's leading steel bull bar manufacturer. This is why we provide you with the best steel bar warranty in Australia - 5 years.

# Important Information

---



## PLEASE READ BEFORE INSTALLATION.

- When installed in accordance with these instructions, the front protection bar does not affect the operation of the vehicles SRS airbags.
- This product must be installed exactly as per these instructions using only hardware supplied.
- Take a few moments to read instructions thoroughly before beginning work.
- In the event of damage to any bar component please contact Uneek4x4 regarding repair/replacement of components.
- Do not use this product for any vehicle make or model other than that specified on these instructions.
- Do not remove labels from this product.
- This product and its fixings must not be modified in any way unless stated in these fitting instructions.
- The installation of this product is recommended for trained personnel.
- These instructions are correct at time of publication. Uneek 4x4 cannot be held responsible for the impact of any changes subsequently made by the vehicle manufacturer.
- During installation it is the duty of the installer to check correct operation/clearances of all components.
- Supplied tow points are designed as tow points only. Use in a recovery operation will be at operator's risk.
- Installation time: 1-2 hours.



### EYE & EAR PROTECTION REQUIRED



### DRILLING REQUIRED



### TWO PERSON LIFT REQUIRED



### TORQUE SETTING



### CUTTING OR GRINDING REQUIRED

#### FASTENER TORQUE SETTINGS:

M6 – 9Nm (4lb ft)

M8 – 22Nm (16lb ft)

M10 – 44Nm (32lb ft)

M12 – 77Nm (57lb ft)

#### TOOLS REQUIRED:

##### BASIC TOOL KIT:

Drill and drill bits up to 12mm.

Angle Grinder and cutting discs

## Components and parts

ITEM NO.	PART NUMBER	DESCRIPTION	QTY.
1	TL-SR-78-ASM3R	TOYOTA 76 BRUSH RAIL CLAMP	2
2	TL-SR-78-ASM3L	TOYOTA 76 BRUSH RAIL CLAMP	2
3	TL-SR-78-ASM1R	SIDE RAIL WELDED ASSY 78 SERIES	1
4	TL-SR-78-ASM1L	SIDE RAIL WELDED ASSY 78 SERIES	1
5	M8X70 BHCS	M8X70 BUTTON HEAD CAP SCREW Z/P	6
6	M8 FN	FLANGE NUT M8	6
7	M10X30	M10 X 1.5 X 30MM BOLT	6
8	M10SW	M10 SPRING WASHER	6
9	M10FWX25	M10 FLAT WASHER X 25MM WIDE	6
10	04-0724	TOYOTA BRUSH RAIL LOGO PLATE RH	2
11	04-0723	TOYOTA BRUSH RAIL LOGO PLATE LH	2

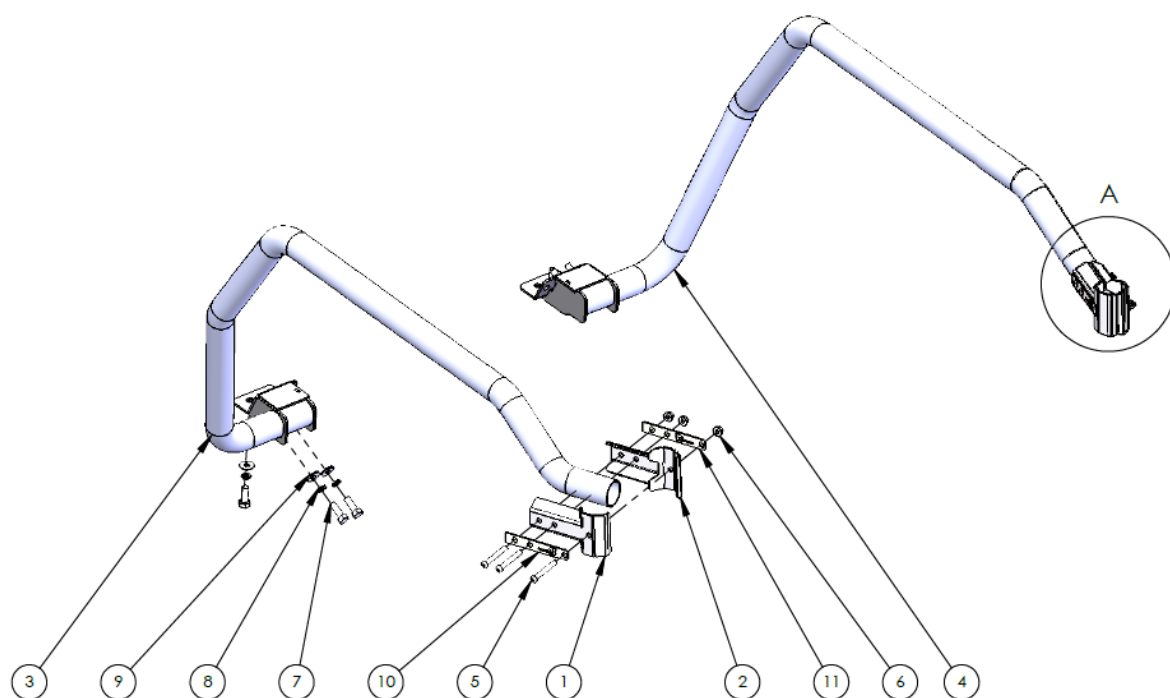

NOTE: CHAMFER TO FACE UPWARDS  
(CLAMPS DESIGNED TO SUIT BULLBAR TUBES)

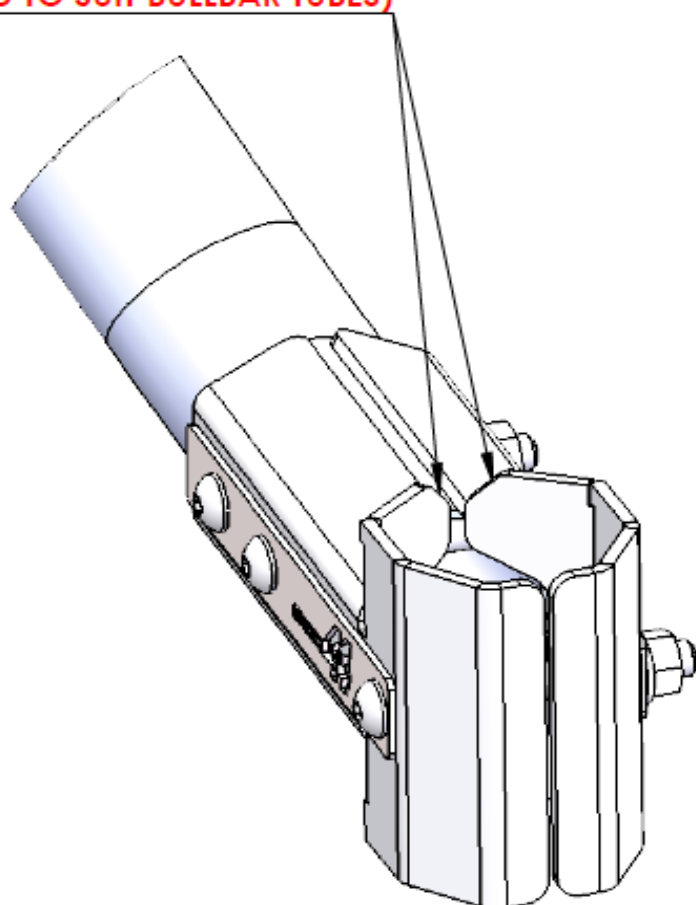

DETAIL A  
SCALE 1 : 2

## Step 1

Fasten the side rail onto the Uneek rock slider with the M10x30 bolt, M10 spring washer and the M10 flat washer. It will require second person to assist placing side rails into position.

PART NUMBER	DESCRIPTION	QTY.
M10X30	M10 X 1.5 X 30MM BOLT	6
M10SW	M10 SPRING WASHER	6
M10FWX25	M10 FLAT WASHER X 25MM WIDE	6

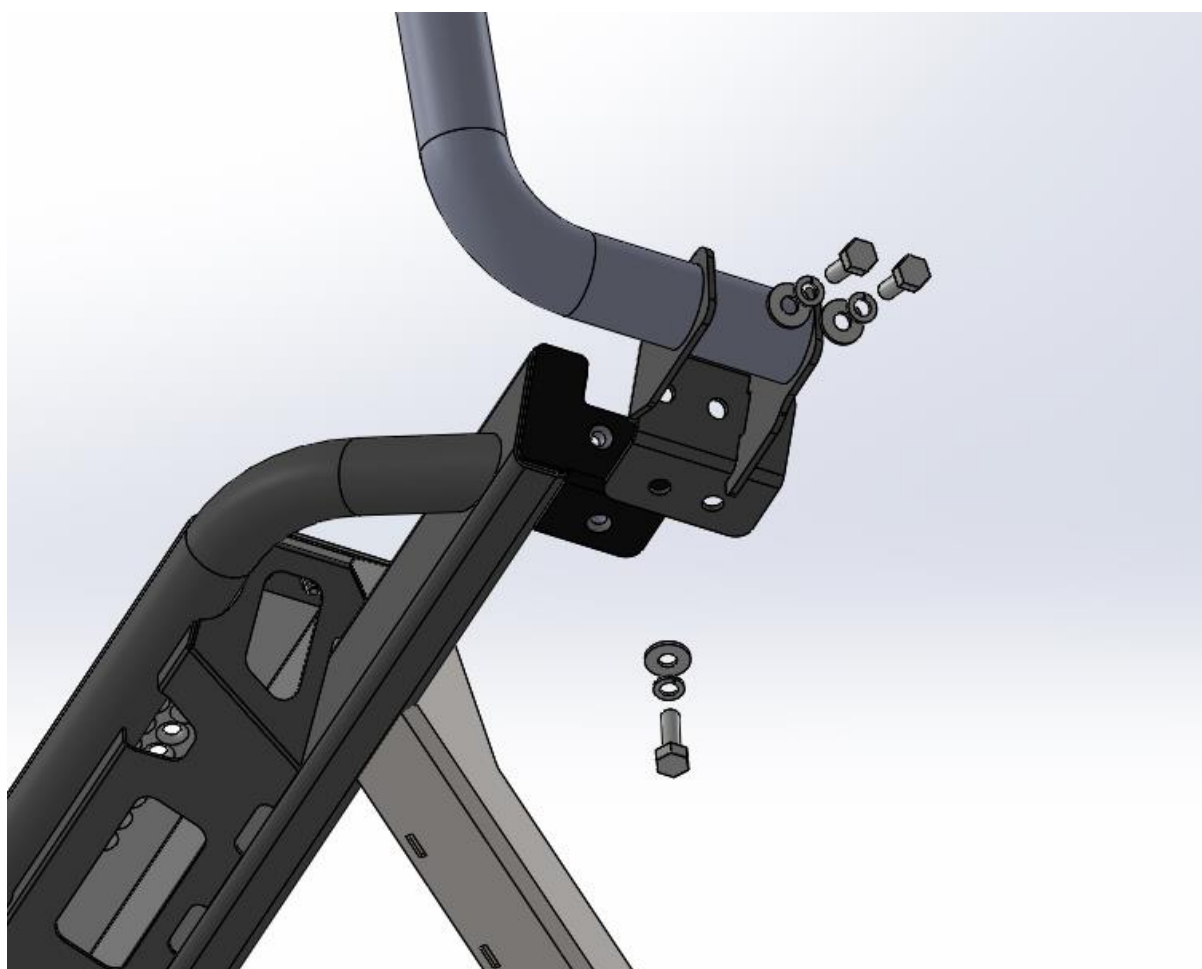

## Step 2

Place clamp onto bull bar end of side rail. Please note that the clamps have a chamfer which face upwards for correct installation. This is to fit correctly to the slight angle of the bullbar tube.

If the tube is too long, mark the tube with tape, take side rail off vehicle and cut to length.

NOTE: CHAMFER TO FACE UPWARDS  
(CLAMPS DESIGNED TO SUIT BULLBAR TUBES)

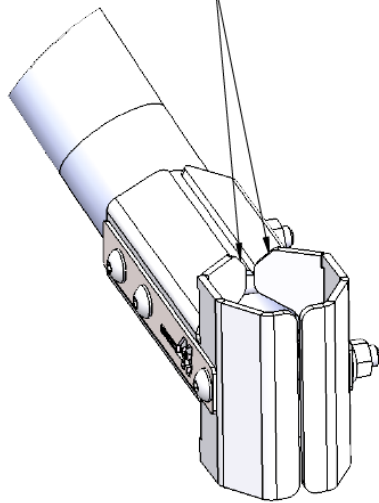

DETAIL A  
SCALE 1 : 2





---

## Step 3

Use a one-handed bar clamp to secure the metal side rail clamps to the side rail tube and the outer tube of the bulbar. Mark the two holes onto the side rail tube and drill through  $\varnothing 8.5$ .

Make sure holes pass through the side rail tube and a bolt can be placed through.

**Note: Hole spacing on the clamp for the side rail is 30mm centre to centre**



---

## Step 4

Fasten the side rail clamps with the M8x70 bolt, left & right logo plate and the M8 flange nut.

Mark the hole in the bull bar side tube and when you are confident the rails are in position, drill a hole using a  $\varnothing 8.5$  drill bit.

**Note: Drill bit must be at least 50mm long to go through tube.**

PART NUMBER	DESCRIPTION	QTY.
04-0723	TOYOTA BRUSH RAIL LOGO PLATE LH	2
04-0724	TOYOTA BRUSH RAIL LOGO PLATE RH	2
M8X70 BHCS	M8X70 BUTTON HEAD CAP SCREW Z/P	4
M8 FN	FLANGE NUT M8	4

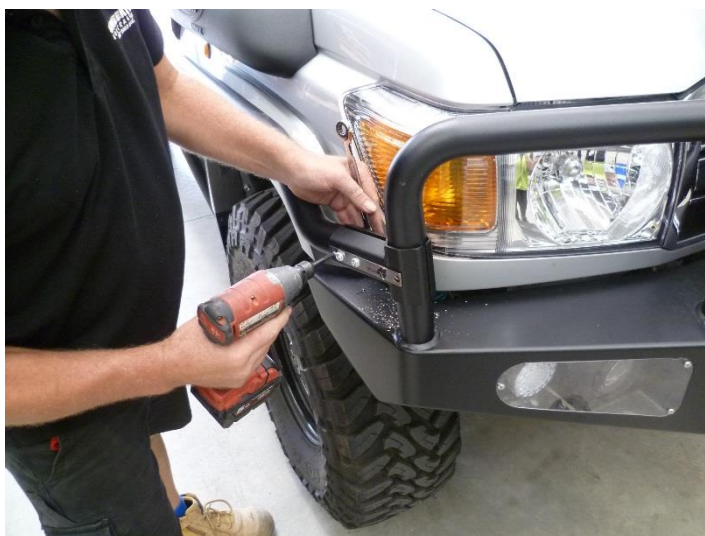

## Step 5

Fasten the remaining M8x70 bolt and flange nut through the new holes in the bull bar outer tubes and clamp.

PART NUMBER	DESCRIPTION	QTY.
M8X70 BHCS	M8X70 BUTTON HEAD CAP SCREW Z/P	2
M8 FN	FLANGE NUT M8	2



## ***Finished Product***

---



Revised: 02/03/2020

***Australia's Best  
Off Road Products  
Created... Not Cloned***

20 Gateway Drive, Carrum Downs, VIC, 3201

1800 806 952

[www.uneek4x4.com.au](http://www.uneek4x4.com.au)

